

Resilient Wetlands: Enhancing Coastal Protection and Water Quality

A NHDES Coastal Resilience Grant

New Hampshire
Seacoast Greenway



Banfield Wetland Restoration Area



WETLAND

Banfield Road



Peirce Island Road

Restoration Area

PISCATAQUA RIVER

850 Banfield Road Site

EXISTING CONDITIONS: NATIVE PLANT IMAGES

Insert image of
existing conditions



Blue Flag Iris emerging in the wetland in early spring.



Above: White Oak Leaf.
Below: Swamp Rose buds.

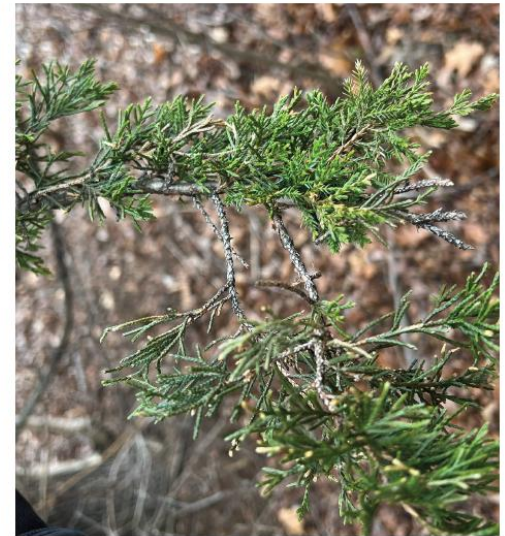

Eastern Red Cedar branches stand out against the brown early spring landscape.



Peirce Island Site

EXISTING CONDITIONS: NATIVE PLANT IMAGES



Crab Apple branch and buds.



Black Cherry branch and buds.



Planting Lists

Matthew Cunningham Landscape Design made multiple visits to each site to determine the best plants and plant sizes for the conditions at each site.

Each site is being planted with some perennials, shrubs and tree types that are already on site. In addition, they have included species that will help diversify the areas and create better wildlife and pollinator habitat.



PLANTING SCHEDULE					
ID	Qty	Latin Name	Common Name	Scheduled Size	Notes
PEIRCE ISLAND					
TREES					
NS	1	Nyssa sylvatica	Black Tupelo	4-6' ht.	conservation grade
PS	3	Prunus serotina	Black Cherry	4-6' ht.	conservation grade
PV	2	Prunus virginiana	Chokecherry	3-4' ht.	conservation grade
SHRUBS					
AA	10	Amelanchier arborea	Downy Serviceberry	#3 cont.	8' O.C.
CP	25	Comptonia peregrina	Sweetfern	#1 cont.	4' O.C.
MG	15	Myrica gale	Sweetgale	#3 cont.	4' O.C.
MP	15	Myrica pensylvanica	Northern Bayberry	#3 cont.	5" O.C.
PM	10	Prunus maritima	Beach Plum	#3 cont.	5' O.C.
RT	10	Rhus typhina	Staghorn Sumac	#3 cont.	5' O.C.
RV	10	Rosa virginiana	Virginia Rose	#3 cont.	4' O.C.
VDE	8	Viburnum dentatum	Arrowwood Viburnum	#3 cont.	6' O.C.
PERENNIALS					
AT	20	Asclepias tuberosa	Butterfly Milkweed	#1 cont.	24" O.C.
EDB	25	Eupatorium dubium 'Baby Joe'	Baby Joe Pye Weed	#1 cont.	24" O.C.
SC	30	Schizachyrium scoparium	Little Bluestem	#1 cont.	24" O.C.
SS	30	Solidago sempervirens	Seaside Goldenrod	#1 cont.	24" O.C.
SO	20	Symphotrichum oblongifolium 'Raydon's Favorite'	Aromatic Aster	#1 cont.	24" O.C.
BANFIELD ROAD					
TREES					
AR	3	Acer rubrum	Red Maple	4-6' ht.	conservation grade
AS	2	Acer saccharinum	Silver Maple	4-6' ht.	conservation grade
PS	8	Prunus serotina	Black Cherry	4-6' ht.	conservation grade
LL	3	Larix laricina	Tamarack	4-6' ht.	conservation grade
SHRUBS					
AA	15	Amelanchier arborea	Downy Serviceberry	#3 cont.	8' O.C.
CL	35	Clethra alnifolia	Summersweet	#3 cont.	4' O.C.
CAM	30	Cornus amomum	Silky Dogwood	#3 cont.	5' O.C.
IV	30	Ilex verticillata	Winterberry	#3 cont.	4' O.C.
MG	25	Myrica gale	Sweetgale	#3 cont.	4' O.C.
MP	15	Myrica pensylvanica	Northern Bayberry	#3 cont.	5' O.C.
VDE	20	Viburnum dentatum	Arrowwood Viburnum	#3 cont.	6' O.C.
PERENNIALS					
AI	20	Asclepias incarnata	Swamp Milkweed	#1 cont.	36" O.C.
EP	20	Eupatorium purpureum	Joe Pye Weed	#1 cont.	36" O.C.
IV	20	Iris versicolor	Blue Flag Iris	#1 cont.	36" O.C.
SC	40	Schizachyrium scoparium	Little Bluestem	#1 cont.	36" O.C.
SR	30	Solidago rugosa	Rough Goldenrod	#1 cont.	36" O.C.

MATTHEW CUNNINGHAM LANDSCAPE DESIGN LLC

411 MAIN STREET, STONEHAM, MA 02180 | 366 FORE STREET, PORTLAND, ME 04101

www.matthew-cunningham.com

CITY OF PORTSMOUTH
WETLAND BUFFER PLANTING
PEIRCE ISLAND & BANFIELD RD

12 May 2026

LAND MANAGEMENT PLAN

A NARRATIVE FOR INVASIVE MANAGEMENT & NATIVE PLANT RESTORATION
AT INLAND WETLAND SITE



BANFIELD WETLAND BUFFER RESTORATION



LAND MANAGEMENT PLAN

A NARRATIVE FOR INVASIVE MANAGEMENT & NATIVE PLANT RESTORATION
AT TIDAL WETLAND SITE



PIERCE WETLAND BUFFER RESTORATION



Land Management Plan

Includes:

- Existing Conditions
- Invasive species inventory
- General & specialized invasive plant management techniques
- Restoration planting recommendations
- Recommended plant list
- Native plant restoration techniques
- Maintenance tips
- Management calendar for treatment and planting



- General Notes:
- Existing conditions from aerial imagery and GIS data provided by City of Portsmouth, NH on March 4, 2020.
 - Existing conditions supplemented from data collected by Matthew Cunningham Landscape Design LLC, 411 Main Street, Stonham, MA 02108 / 266 Fore Street, Portland, ME 04101 - tel: (617) 905.2246

- Planting Notes:
- The contractor shall supply all plant material in quantities sufficient to complete the planting shown on all drawings.
 - All plant material shall conform to the guidelines established by "The American Standard for Nursery Stock" published by The American Association of Nurserymen, latest edition.
 - All plant material shall be warranted for 1 year after substantial completion.
 - All plants shall be balled and burlap unless otherwise noted on the plant list/schedule.
 - All plants shall be approved by landscape Designer prior to their installation on the site.
 - Contractor shall stake all plant locations in the field. Obtain approval of landscape Designer before starting plant installations.
 - Plants to be transplanted shall be tagged and exact planting locations noted in the field.
 - All areas disturbed by construction shall be restored to a pre-construction state unless otherwise noted by landscape architect or plants.



Planting Plan:

850 Banfield Road

PLANTING LEGEND:

- PROPERTY LINE
- 100' WETLAND BUFFER
- WETLAND
- PROPOSED DECIDUOUS TREE PLANTING
- PROPOSED EVERGREEN TREE PLANTING
- PROPOSED SHRUB PLANTING
- PROPOSED PERENNIAL PLANTING

PLANTING SCHEDULE

ID	Qty	Latin Name	Common Name	Scheduled Size	Notes
BANFIELD ROAD					
TREES					
AR	3	Acer rubrum	Red Maple	4-6' ht.	conservation-grade
ASA	2	Acer rubrum 'Red Sunset'	Red Sunset Red Maple	4-6' ht.	conservation-grade
LL	3	Larix laricina	Tamarack	4-6' ht.	conservation-grade
PRS	9	Prunus serotina	Black Cherry	4-6' ht.	conservation-grade
SHRUBS					
AA	15	Amelanchier arborea	Downy Serviceberry	#3 cont.	8' O.C.
CL	30	Caesia sinibolia	Summersweet	#3 cont.	4' O.C.
CAM	30	Cornus amomum	Silky Dogwood	#3 cont.	5' O.C.
IV	30	Ilex verticillata	Winterberry	#3 cont.	4' O.C.
MG	25	Myrica gale	Sweetgale	#3 cont.	4' O.C.
MP	15	Myrica pensylvanica	Northern Bayberry	#3 cont.	5' O.C.
VDE	20	Viburnum dentatum	Aronwood Viburnum	#3 cont.	8' O.C.
PERENNIALS					
AT	20	Asclepias tuberosa	Butterfly Milkweed	#1 cont.	24" O.C.
EBL	20	Eupatorium altissimum 'Bobby Joe'	Bobby Joe Pine Weed	#1 cont.	24" O.C.
SC	30	Schizachyrium scoparium	Little Bluestem	#1 cont.	24" O.C.
SS	30	Solidago sempervirens	Seaside Goldenrod	#1 cont.	24" O.C.
SO	20	Symphoricarpos oblongifolius 'Raydon's Favorite'	Aromatic Asar	#1 cont.	24" O.C.

REVISIONS:

#	DATE	DESCRIPTION

General Notes:

- Existing conditions from aerial imagery and GIS data provided by City of Portsmouth, NH on March 4, 2024.
- Existing conditions supplemented from data collected by Matthew Cunningham Landscape Design LLC, 411 Main Street, Somers, MA 02158 / 366 Fore Street, Portland, ME 04101 - tel: (617) 905 2246

Planting Notes:

- The contractor shall supply all plant material in quantities sufficient to complete the planting shown on all drawings.
- All plant material shall conform to the guidelines established by "The American Standard for Nursery Stock" published by The American Association of Nurserymen, latest edition.
- All plant material shall be warranted for 1 year after substantial completion.
- All plants shall be balled and burlap unless otherwise noted on the plant list/schedule.
- All plants shall be approved by Landscape Designer prior to their installation at the site.
- Contractor shall stake all plant locations in the field. Obtain approval of Landscape Designer before starting plant installations.
- Plants to be transplanted shall be tagged and exact planting locations staked in the field.
- All areas disturbed by construction shall be restored to pre-construction state unless otherwise noted by landscape architect or plans.



Planting Plan: Peirce Island

PLANTING LEGEND:

- PROPERTY LINE / LIMIT OF WORK
- PROPOSED DECIDUOUS TREE PLANTING (XX)
- PROPOSED EVERGREEN TREE PLANTING (XX)
- PROPOSED SHRUB PLANTING (XX)
- PROPOSED PERENNIAL PLANTING (XX)

PLANTING SCHEDULE

ID	Qty	Latin Name	Common Name	Scheduled Size	Notes
PEIRCE ISLAND					
TREES					
NS	1	<i>Nyssa sylvatica</i>	Tupelo	4-6' ht	conservation-grade
PRS	3	<i>Prunus serotina</i>	Black Cherry	4-6' ht	conservation-grade
PVI	1	<i>Prunus virginiana</i>	Chokecherry	3-4' ht	conservation-grade
SHRUBS					
AA	10	<i>Amelanchier arborea</i>	Downy Serviceberry	#3 cont	18" O.C.
OP	25	<i>Comptonia pergrina</i>	Sweetfern	#1 cont	18" O.C.
MG	15	<i>Myrica gale</i>	Sweetgale	#3 cont	18" O.C.
MP	15	<i>Myrica pensylvanica</i>	Northern Bayberry	#3 cont	18" O.C.
PM	10	<i>Prunus maritima</i>	Beach Plum	#3 cont	18" O.C.
RT	10	<i>Rosa blanda</i>	Staghorn Sumac	#3 cont	18" O.C.
RV	10	<i>Rosa virginiana</i>	Virginia Rose	#3 cont	18" O.C.
VDE	8	<i>Viburnum dentatum</i>	Arrowwood Viburnum	#3 cont	18" O.C.
PERENNIALS					
AT	20	<i>Asclepias tuberosa</i>	Butterfly Milkweed	#1 cont	24" O.C.
EQB	25	<i>Equisetum diatum</i> 'Baby Jew'	Baby Joe Five Weed	#1 cont	24" O.C.
SC	30	<i>Schizachyrium scoparium</i>	Little Bluestem	#1 cont	24" O.C.
SS	30	<i>Solidago sempervirens</i>	Seaside Goldenrod	#1 cont	24" O.C.
SC	20	<i>Symphoricarpos alabangifolium</i> 'Raydon's Favorite'	Aromatic Aster	#1 cont	24" O.C.

Enhancing Freshwater Wetland Health & Community Awareness

Next Steps

- Design & order educational signage for each site
- Design & order postcards for wetland education and a link to the new online webpage
- Finalize and publish online website

Text box explaining what a wetland is, what a freshwater wetland is, what this wetland feeds into, the importance of buffers, different wetland buffer benefits (wildlife corridors, habitat, food source, stormwater filtration, pollinator, etc.)

For more information on this buffer restoration project, what you can do in your own wetland buffer and for more information on wetlands in Portsmouth, scan this QR code or go to (insert tiny url).

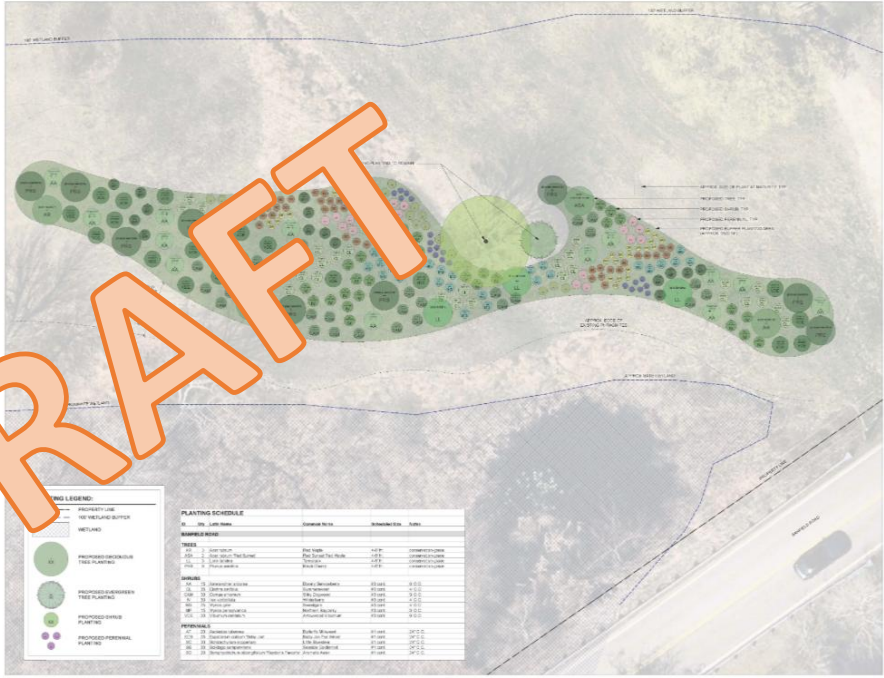

This restoration project was performed in partnership with Mathew Cunningham Landscape Design and Parterre Ecological. This project was made possible through grant funding from the New Hampshire Department of Environmental Services Coastal Resilience Grants (CRG) Program and the Great Bay Resource Protection Partnership (GBRPP).

