

DRAIN MANHOLE
SCALE: N.T.S

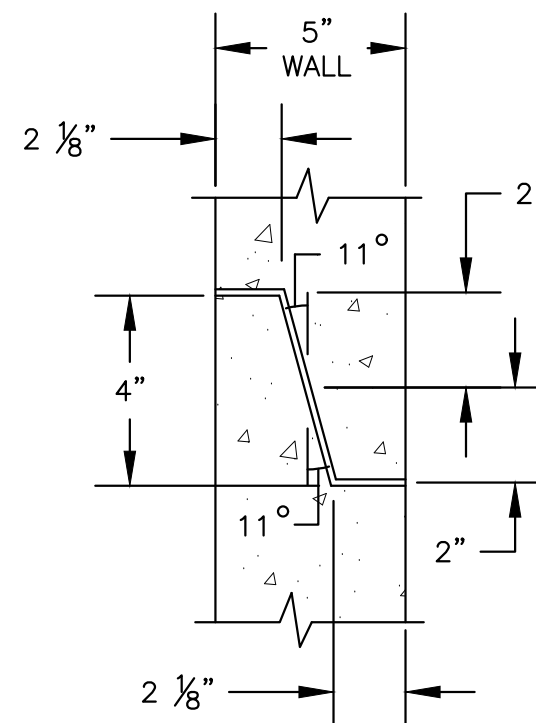

NOTES:

1. SUMP BASE, BARRELS AND TOP (CONE OR FLAT) SECTIONS SHALL BE PRECAST REINFORCED CONCRETE (4,000psi AT 28-DAY).
2. ECCENTRIC CONE TOPS ARE REQUIRED. FLAT TOPS REQUIRE ENGINEER APPROVAL.
3. STRUCTURE SHALL BE DESIGNED FOR HS-20 LOAD RATING.
4. IN THE EVENT THAT SHIPLAP JOINTS OCCUR BELOW INVERT OUT PIPE, THE HORIZONTAL JOINT SHALL BE SEALED FOR WATER TIGHTNESS USING A DOUBLE ROW OF ELASTOMERIC (KENT SEAL OR EQUAL) OR MASTIC SEALANT.
5. CIRCUMFERENTIAL REINFORCEMENT SHALL BE 0.12 SQ. IN. PER LINEAR FT. IN ALL SECTIONS & SHALL BE PLACED IN THE CENTER THIRD OF WALL.
6. THE TONGUE OR THE GROOVE OF THE JOINT SHALL CONTAIN ONE LINE OF CIRCUMFERENTIAL REINFORCEMENT EQUAL TO 0.12 SQ. IN. PER LINEAR FT.
7. EACH CASTING TO HAVE LIFTING HOLES CAST IN.
8. LADDER RUNGS SHALL BE OMITTED.
9. SUITABLE MATERIAL FOR BACKFILL SHALL BE THE NATURAL MATERIAL EXCAVATED DURING CONSTRUCTION, BUT SHALL EXCLUDE DEBRIS, PIECES OF PAVEMENT, ORGANIC MATTER, TOP SOIL, MUCK, PEAT OR CLAY, EXCAVATED LEDGE MATERIAL, AND ANY OTHER ROCKS OVER SIX INCHES IN LARGEST DIMENSION, OR ANY MATERIALS DEEMED TO BE UNACCEPTABLE BY THE ENGINEER. BACKFILL MATERIAL PLACED AROUND THE STRUCTURE SHALL BE COMPACTED IN 6" LIFTS WITH A JUMPING JACK STYLE COMPACTOR.
10. THERE SHALL BE A 0.10' (MIN.) ELEVATION DIFFERENCE BETWEEN THE INVERT IN AND INVERT OUT.

REFERENCES:

CITY OF
PORTSMOUTH
STANDARD
TECHNICAL
SPECIFICATIONS

DEPARTMENT OF
PUBLIC WORKS
CITY OF PORTSMOUTH, NH
680 PEVERLY HILL ROAD
603-427-1530



DATE: 05/09/2025
SCALE: NONE
PROJ. NO.: N/A
APVD BY: PHR

PROJECT:
CITY OF PORTSMOUTH
STANDARD DETAILS

TITLE:
DRAIN MANHOLE

SHEET:
D-003