



# City of Portsmouth, New Hampshire

## Plans for the Construction of CHEVROLET AVENUE SIDEWALKS PROJECT #7231 Summer 2021

PREPARED FOR: City of Portsmouth, New Hampshire  
Department of Public Works  
680 PEVERLY HILL ROAD  
PORTSMOUTH, NH 03801

SURVEY BY: Ambit Engineering, Inc.  
200 Griffin Road, Unit 3  
Portsmouth, NH 03801

PREPARED BY: **SEAPORT**  
ENGINEERING  
Portsmouth, NH 03801  
(603) 498-8449  
www.seaporteng.com

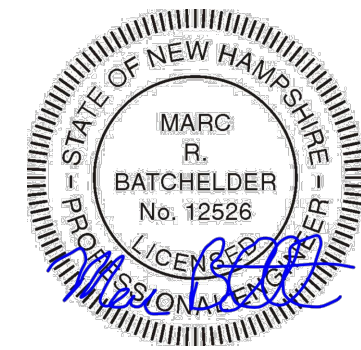

LOCATION PLAN

### INDEX OF DRAWINGS

INDEX	LATEST REV.
C-001	GENERAL NOTES
C-101	EXISTING CONDITIONS / DEMOLITION LAYOUT PLAN
C-102	PROPOSED LAYOUT PLAN
C-103	GRADING, DRAINAGE & UTILITY PLAN
C-201	EROSION CONTROLS - NOTES & DETAILS
C-202	CONSTRUCTION DETAILS
C-203	CONSTRUCTION DETAILS

# FOR CONSTRUCTION

05/06/2021

**DEMOLITION NOTES:**

- LOCATIONS OF UNDERGROUND UTILITIES ARE APPROXIMATE AND NOT GUARANTEED. CONTRACTOR SHALL LOCATE ALL UTILITIES, ANTICIPATE CONFLICTS, REPAIR AND/OR RELOCATE EXISTING UTILITIES REQUIRED TO COMPLETE THE WORK.
- MATERIAL TO BE REMOVED SHALL BECOME THE PROPERTY OF THE CONTRACTOR UNLESS OTHERWISE NOTED. DISPOSAL SHALL BE IN ACCORDANCE WITH ALL FEDERAL, STATE AND LOCAL REGULATIONS.
- ANY DAMAGE BY THE CONTRACTOR DURING DEMOLITION AND/OR CONSTRUCTION SHALL BE REPAIRS OR REPLACED BY THE CONTRACTOR AT NO ADDITIONAL COST TO THE OWNER.
- CONTRACTOR SHALL OBTAIN AND PAY FOR ALL PERMITS AND FEES NECESSARY TO COMPLETE THE WORK.
- CONTRACTOR SHALL REMOVE TREES AND BRUSH AS INDICATED AND AS REQUIRED FOR COMPLETION OF THE WORK. ALL STUMPS SHALL BE REMOVED AND SURFACES GRUBBED WITHIN THE LIMITS OF WORK.
- ALL WORK WITHIN THE PUBLIC RIGHT OF WAY SHALL BE COORDINATED WITH THE CITY OF PORTSMOUTH.
- EROSION CONTROL MEASURES SHALL BE INSTALLED PRIOR TO THE START OF ANY CLEARING OR DEMOLITION WORK. THIS INCLUDES SILT FENCE / SILT SOCK AND INLET PROTECTION BARRIERS.
- CONTRACTOR SHALL SAWCUT PAVEMENT AT EDGES OF TRENCHES FOR CLEAN VERTICAL EDGES.
- CONTRACTOR SHALL COORDINATE WITH ALL APPLICABLE UTILITIES. WORK ASSOCIATED WITH UTILITIES, BUT NOT LIMITED TO: SITE LIGHTING.
- CONTRACTOR SHALL NOTIFY DIG-SAFE 72 HOURS PRIOR TO ANY WORK STARTING. CONTRACTOR REQUIRED TO MAINTAIN AN ACTIVE DIG-SAFE PERMIT THROUGHOUT THE DURATION OF CONSTRUCTION.
- CONTRACTOR SHALL INSTALL ORANGE CONSTRUCTION FENCING AROUND EXISTING TREES TO A DISTANCE APPROVED BY THE CITY ARBORIST. NO EQUIPMENT SHALL BE ALLOWED WITHIN THE TREE PROTECTION AREAS.

**GRADING NOTES:**

- CONTRACTOR SHALL PROVIDE A FINISH PAVEMENT SURFACE FREE OF LOW SPOTS AND PONDING AREAS. THE INTENT OF FINAL GRADING IS TO CREATE SIDEWALKS AND ROADS TO MATCH STOOPS OF HOMES AND GRADES OF EXISTING DRIVEWAYS TO THE BEST EXTENT POSSIBLE.
- ALL DISTURBED AREAS THAT ARE NOT TO BE PAVED OR OTHERWISE TREATED SHALL RECEIVE 6" LOAM, SEED FERTILIZER AND MULCH.
- CONTRACTOR SHALL PROVIDE THE FOLLOWING MINIMUM REQUIREMENTS FOR COMPACTION:
 

BELOW PAVEMENT AND CONCRETE AREAS:	95%
TRENCH BEDDING AND BACKFILL:	95%
BELOW LOAM AND SEED AREAS:	90%

 COMPACTION PERCENTAGES SHALL BE THE MAXIMUM DRY DENSITY AT OPTIMUM MOISTURE CONTENT IN ACCORDANCE WITH ASTM D-1557, METHOD C. FIELD DENSITY TESTS SHALL BE CONDUCTED IN ACCORDANCE WITH ASTM D-1556 OR ASTM-2922.

**SITE NOTES:**

- ALL WORK SHALL CONFORM TO THE CITY OF PORTSMOUTH DEPARTMENT OF PUBLIC WORKS STANDARD SPECIFICATIONS.
- CONTRACTOR SHALL PROVIDE AS-BUILT PLANS (MYLAR AND .DWG FORMAT AUTOCAD FILES) TO THE CITY OF PORTSMOUTH UPON COMPLETION OF THE PROJECT. AS-BUILT SHALL BE PREPARED AND CERTIFIED BY A LAND SURVEYOR OR PROFESSIONAL ENGINEER LICENSED IN THE STATE OF NEW HAMPSHIRE.
- MATERIALS AND CONSTRUCTION SHALL COMPLY TO ALL APPLICABLE FEDERAL, STATE AND LOCAL CODES AND SPECIFICATIONS.
- CONTRACTOR SHALL PROVIDE A LICENSED ENGINEER OR SURVEYOR TO DETERMINE ALL LINES AND GRADE.
- CONTRACTOR IS RESPONSIBLE TO MAINTAIN ALL VERTICAL AN HORIZONTAL CONTROL FOR THE PROJECT.
- PAVEMENT MARKINGS AND SIGNS SHALL CONFORM TO THE "MANUAL ON UNIFORM CONTROL DEVICES". "STANDARD ALPHABETS FOR HIGHWAY SIGNS AND PAVEMENT MARKINGS".
- CONTRACTOR SHALL SUBMIT A MAINTENANCE OF TRAFFIC PLAN TO THE CITY OF PORTSMOUTH FOR APPROVAL.
- CONTRACTOR SHALL BE FAMILIAR WITH ALL AMERICAN WITH DISABILITY ACT (ADA) REQUIREMENTS FOR ACCESSIBILITY.

**PROJECT NAME AND LOCATION:**

CHEVROLET AVENUE SIDEWALKS  
PORTSMOUTH, NEW HAMPSHIRE

**DESCRIPTION:**

THE PROJECT CONSISTS OF REALIGNMENT OF CURBING ALONG THE NORTH SIDE OF CHEVROLET AVENUE AND CONSTRUCTION OF A PEDESTRIAN SIDEWALK. ROADWAY WILL BE RESURFACED AND RE-STRIPE.

**CONSTRUCTION SEQUENCE:**

- INSTALL ALL EROSION CONTROL MEASURES.
- REMOVE AND STORE PRIVATE PROPERTY FENCING AND LANDSCAPING TO BE RE-USED.
- REMOVE EXISTING GRANITE CURB ON NORTH SIDE OF STREET, STORE FOR RE-USE.
- CONSTRUCT ROADWAY BASE IN SELECT LOCATIONS.
- RE-SET CURB ON NORTH SIDE OF STREET, SET NEW CURB AT SELECT LOCATIONS.
- CONSTRUCT SIDEWALK BASE BEHIND CURB ON NORTH SIDE OF STREET.
- CONSTRUCT SIDEWALK.
- MILL, RESURFACE AND RE-STRIPE ROADWAY.
- RE-INSTALL PRIVATE PROPERTY FENCE AND LANDSCAPING. COMPLETE RESTORATION ON BACK SIDE OF SIDEWALK.
- WHEN CONSTRUCTION ACTIVITY IS COMPLETE AND SITE IS STABILIZED, REMOVE EROSION CONTROL MEASURES.

**EROSION AND SEDIMENT CONTROLS AND STABILIZATION PRACTICES:**

THE EROSION CONTROL PROCEDURES SHALL CONFORM TO SECTION 645 OF THE "STANDARD SPECIFICATION FOR ROAD AND BRIDGE CONSTRUCTION" OF THE NHDOT, AND "STORM WATER MANAGEMENT AND EROSION AND SEDIMENT CONTROL HANDBOOK FOR URBAN AND DEVELOPING AREAS IN NEW HAMPSHIRE".

DURING CONSTRUCTION AND THEREAFTER, EROSION CONTROL MEASURES ARE TO BE IMPLEMENTED AS NOTED. THE SMALLEST PRACTICAL AREA OF LAND SHOULD BE EXPOSED AT ANY ONE TIME DURING CONSTRUCTION, BUT IN NO CASE SHALL EXCEED 5 ACRES AT ANY ONE TIME BEFORE DISTURBED AREAS ARE STABILIZED.

AN AREA SHALL BE CONSIDERED STABLE IF ONE OF THE FOLLOWING HAS OCCURRED:

- BASE COURSE GRAVELS HAVE BEEN INSTALLED IN AREAS TO BE PAVED;
- A MINIMUM OF 85% VEGETATED GROWTH HAS BEEN ESTABLISHED;
- A MINIMUM OF 3" OF NON-EROSIVE MATERIAL SUCH AS STONE OR RIPRAP HAS BEEN INSTALLED; OR
- EROSION CONTROL BLANKETS HAVE BEEN PROPERLY INSTALLED.

ANY DISTURBED AREAS WHICH ARE TO BE LEFT TEMPORARILY, AND WHICH WILL BE REGRADED LATER DURING CONSTRUCTION SHALL BE MACHINE HAY MULCHED AND SEEDED WITH RYE GRASS TO PREVENT EROSION.

DUST CONTROL: IF TEMPORARY STABILIZATION PRACTICES, SUCH AS TEMPORARY VEGETATION AND MULCHING, DO NOT ADEQUATELY REDUCE DUST GENERATION, APPLICATION OF WATER OR CALCIUM CHLORIDE SHALL BE APPLIED IN ACCORDANCE WITH BEST MANAGEMENT PRACTICES.

ALL EROSION CONTROLS SHALL BE INSPECTED WEEKLY DURING THE LIFE OF THE PROJECT AND AFTER EACH STORM OF 0.5" OR GREATER. ALL DAMAGED SILT FENCES SHALL BE REPAIRED. SEDIMENT DEPOSITS SHALL PERIODICALLY BE REMOVED AND DISPOSED IN A SECURED LOCATION.

AVOID THE USE OF FUTURE OPEN SPACES (LOAM AND SEED AREAS) WHEREVER POSSIBLE DURING CONSTRUCTION. CONSTRUCTION TRAFFIC SHALL USE THE ROADBEDS OF FUTURE ACCESS DRIVES AND PARKING AREAS.

TOPSOIL REQUIRED FOR THE ESTABLISHMENT OF VEGETATION SHALL BE STOCKPILED IN AMOUNTS NECESSARY TO COMPLETE FINISHED GRADING OF ALL EXPOSED AREAS. CONSTRUCT SILT FENCE AROUND TOPSOIL STOCKPILE.

ALL FILLS SHALL BE PLACED AND COMPACTED TO REDUCE EROSION, SLIPPAGE, SETTLEMENT, SUBSIDENCE OR OTHER RELATED PROBLEMS.

DISTURBED AREAS SHALL BE SEEDED WITHIN 72 HOURS FOLLOWING FINISHED GRADING.

AT NO TIME SHALL ANY DISTURBED AREA REMAIN UNSTABILIZED FOR LONGER THAN 72 HOURS. ALL AREAS WHERE CONSTRUCTION IS NOT COMPLETE WITHIN THIRTY DAYS OF THE INITIAL DISTURBANCE SHALL BE MACHINE HAY MULCHED AND SEEDED WITH RYE GRASS TO PREVENT EROSION.

**INSTALLATION PROCEDURES OF EROSION AND SEDIMENT CONTROLS:**

**A. VEGETATIVE PRACTICE**

FOR PERMANENT MEASURES AND PLANTINGS FROM EARLY SPRING TO SEPTEMBER 30:

LIMESTONE SHALL BE THOROUGHLY INCORPORATED INTO THE LOAM LAYER AT A RATE OF 2 TONS PER ACRE.

FERTILIZER SHALL BE SPREAD ON THE TOP LAYER OF LOAM AND WORKED INTO THE SURFACE. FERTILIZER APPLICATION RATE SHALL BE 500 POUNDS PER ACRE OF 10-20-20 FERTILIZER.

SEED SHALL BE SOWN AT THE RATES SHOWN IN THE TABLE BELOW. IMMEDIATELY BEFORE SEEDING, THE SOIL SHALL BE LIGHTLY RAKED. ONE HALF THE SEED SHALL BE SOWN IN ONE DIRECTION AND THE OTHER HALF AT RIGHT ANGLES TO THE ORIGINAL DIRECTION. IT SHALL BE LIGHTLY RAKED INTO THE SOIL TO A DEPTH NOT OVER 1/4 INCH AND ROLLED WITH A HAND ROLLER WEIGHING NOT OVER 100 POUNDS PER LINEAR FOOT OF WIDTH. HAY MULCH SHALL BE APPLIED IMMEDIATELY AFTER SEEDING AT A RATE OF 1.5 TO 2 TONS PER ACRE, AND SHALL BE HELD IN PLACE USING APPROPRIATE TECHNIQUES FROM THE EROSION AND SEDIMENT CONTROL HANDBOOK.

THE SURFACE SHALL BE WATERED AND KEPT MOIST WITH A FINE SPRAY AS REQUIRED, WITHOUT WASHING AWAY THE SOIL, UNTIL THE GRASS IS WELL ESTABLISHED. ANY AREAS WHICH ARE NOT SATISFACTORILY COVERED SHALL BE RESEEDED, AND ALL NOXIOUS WEEDS REMOVED.

A GRASS SEED MIXTURE CONTAINING THE FOLLOWING SEED REQUIREMENTS SHALL BE:

GENERAL COVER	SEEDING RATE
CREEPING RED FESCUE	100 LBS/ACRE
KENTUCKY BLUEGRASS	100 LBS/ACRE

**SLOPE SEED (ALL SLOPES GREATER THAN OR EQUAL TO 3:1)**

CREEPING RED FESCUE	20 LBS/ACRE
TALL FESCUE	20 LBS/ACRE
BIRDSFOOT TREFOLI	2 LBS/ACRE

IN NO CASE SHALL THE WEED CONTENT EXCEED ONE PERCENT BY WEIGHT. ALL SEED SHALL COMPLY WITH APPLICABLE STATE AND FEDERAL SEED LAWS.

FOR TEMPORARY PROTECTION OF DISTURBED AREAS: MULCHING AND SEEDING SHALL BE APPLIED AT THE FOLLOWING RATES:

PERENNIAL RYE:	0.7 LBS/1,000 S.F.
MULCH:	1.5 TONS/ACRE

**B. MULCHING**

IN ORDER TO BE EFFECTIVE, MULCHING MUST BE IN PLACE PRIOR TO MAJOR STORM EVENTS. THERE ARE TWO TYPES OF STANDARDS: APPLY MULCH PRIOR TO ANY STORM EVENT: THIS IS APPLICABLE WHEN WORKING WITHIN 100 FEET OF WETLANDS. IT WILL BE NECESSARY TO CLOSELY MONITOR WEATHER FORECASTS FOR ADEQUATE WARNING TO SIGNIFICANT STORMS. REQUIRED MULCHING WITHIN SPECIFIED TIME PERIOD: THE TIME PERIOD CAN RANGE FROM 14 TO 21 DAYS OF INACTIVITY IN AN AREA, THE LENGTH OF TIME VARYING WITH SITE CONDITIONS. JUDGEMENT SHALL BE USED TO EVALUATE THE INTERACTION OF SITE CONDITIONS AND THE POTENTIAL FOR IMPACT ON ADJACENT AREAS TO CHOOSE AN APPROPRIATE TIME RESTRICTION. WHEN MULCH IS TO BE APPLIED TO PROVIDE PROTECTION OVER WINTER MONTHS, IT SHALL BE AT A RATE OF 6,000 POUNDS OF HAY OR STRAW PER ACRE. A TACKIFIER SHALL BE ADDED TO THE MULCH.

**C. WINTER NOTES**

ALL PROPOSED VEGETATED AREAS WHICH DO NOT EXHIBIT A MINIMUM OF 85% VEGETATIVE GROWTH BY OCTOBER 15TH, OR WHICH ARE DISTURBED AFTER OCTOBER 15TH, SHALL BE STABILIZED BY SEEDING AND INSTALLING EROSION CONTROL BLANKETS ON SLOPES GREATER THAN 3:1, AND SEEDING AND PLACING 3 TO 4 TONS OF MULCH PER ACRE, SECURED WITH ANCHORED NETTING, ELSEWHERE. THE INSTALLATION OF EROSION CONTROL BLANKETS OR MULCH AND NETTING SHALL NOT OCCUR OVER ACCUMULATED SNOW OR ON FROZEN GROUND AND SHALL BE COMPLETED IN ADVANCE OF THAW OR SPRING MELT EVENTS.

ALL DITCHES OR SWALES WHICH DO NOT EXHIBIT A MINIMUM OF 85% VEGETATIVE GROWTH BY OCTOBER 15TH, OR WHICH ARE DISTURBED AFTER OCTOBER 15TH, SHALL BE STABILIZED TEMPORARILY WITH STONE OR EROSION CONTROL BLANKETS APPROPRIATE FOR THE DESIGN FLOW CONDITIONS.

AFTER NOVEMBER 15TH, INCOMPLETE ROAD OR PARKING SURFACES, WHERE WORK HAS STOPPED FOR THE WINTER SEASON, SHALL BE PROTECTED WITH A MINIMUM OF 3 INCHES OF CRUSHED GRAVEL PER NHDOT ITEM 304.3.

**MAINTENANCE AND PROTECTION:**

- THE CONTRACTOR SHALL MAINTAIN ALL LOAM & SEED AREAS UNTIL FINAL ACCEPTANCE AT THE COMPLETION OF THE CONTRACT. MAINTENANCE SHALL INCLUDE WATERING, WEEDING, REMOVAL OF STONES AND OTHER FOREIGN OBJECTS OVER 1/2 INCHES IN DIAMETER WHICH MAY APPEAR AND THE FIRST TWO (2) CUTTINGS OF GRASS NO CLOSER THEN TEN (10) DAYS APART. THE FIRST CUTTING SHALL BE ACCOMPLISHED WHEN THE GRASS IS FROM 2 1/2 TO 3 INCHES HIGH. ALL BARE AND DEAD SPOTS WHICH BECOME APPARENT SHALL BE PROPERLY PREPARED, LIMED AND FERTILIZED, AND RESEDED BY THE CONTRACTOR AT HIS EXPENSE AS MANY TIMES AS NECESSARY TO SECURE GOOD GROWTH. THE ENTIRE AREA SHALL BE MAINTAINED, WATERED AND CUT UNTIL ACCEPTANCE OF THE LAWN BY THE OWNER'S REPRESENTATIVE.
- THE CONTRACTOR SHALL TAKE WHATEVER MEASURES ARE NECESSARY TO PROTECT THE GRASS WHILE IT IS DEVELOPING.
- TO BE ACCEPTABLE, SEEDED AREAS SHALL CONSIST OF A UNIFORM STAND OF AT LEAST 90 PERCENT ESTABLISHED PERMANENT GRASS SPECIES, WITH UNIFORM COUNT OF AT LEAST 100 PLANTS PER SQUARE FOOT.
- SEEDED AREAS WILL BE FERTILIZED AND RESEEDED AS NECESSARY TO INSURE VEGETATIVE ESTABLISHMENT.
- THE SWALES WILL BE CHECKED WEEKLY AND REPAIRED WHEN NECESSARY UNTIL ADEQUATE VEGETATION IS ESTABLISHED.
- THE SILT FENCE BARRIER SHALL BE CHECKED AFTER EACH RAINFALL AND AT LEAST DAILY DURING PROLONGED RAINFALL.
- SILT FENCING SHALL BE REMOVED ONCE VEGETATION IS ESTABLISHED, AND DISTURBED AREAS RESULTING FROM SILT FENCE REMOVAL SHALL BE PERMANENTLY SEEDED.

**LEGEND:**

EXISTING	PROPOSED	
---	---	PROPERTY LINE
---	---	RIGHT-OF-WAY LINE
---	---	EDGE OF PAVEMENT
	[Pattern]	SIDEWALK (CONCRETE)
	[Pattern]	WALKWAY (BRICK)
	[Symbol]	SIGN
[Pattern]	[Pattern]	RETAINING WALL
[Symbol]	[Symbol]	FENCE
[Symbol]	[Symbol]	SHRUB
[Symbol]	[Symbol]	TREE
---	---	U/G ELECTRIC
---	---	WATER
---	---	SEWER
---	---	GAS
---	---	DRAIN
[Symbol]	[Symbol]	LIGHT POLE
[Symbol]	[Symbol]	FIRE HYDRANT
[Symbol]	[Symbol]	UTILITY POLE
[Symbol]	[Symbol]	UTILITY POLE w/ LIGHT
[Symbol]	[Symbol]	CATCHBASIN
[Symbol]	[Symbol]	MANHOLE
[Symbol]	[Symbol]	WATER SHUT OFF
[Symbol]	[Symbol]	WATER VALVE
[Symbol]	[Symbol]	EROSION CONTROL
[Symbol]	[Symbol]	SAWCUT

NO.	ISSUED FOR	CONSTRUCTION	DESCRIPTION	APPR'D	DATE
0	MRB				05/06/21

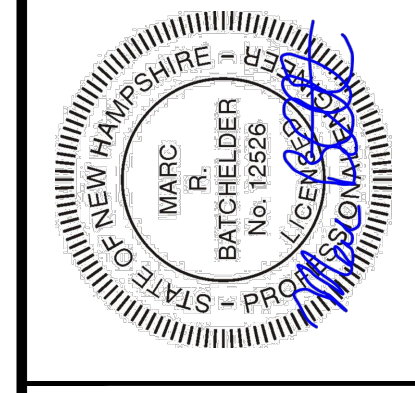

DATE: APRIL 2, 2020  
SCALE: NONE  
PROJECT NO.: C-016  
MARC R. BATCHELDER, PE  
ENGINEER OF RECORD

FOR: City of Portsmouth  
Chevrolet Avenue  
Sidewalk

**Seaport Engineering, LLC**  
PORTSMOUTH, NH  
(603) 498-8449  
www.seaporteng.com

TITLE: GENERAL NOTES and LEGEND

C-001

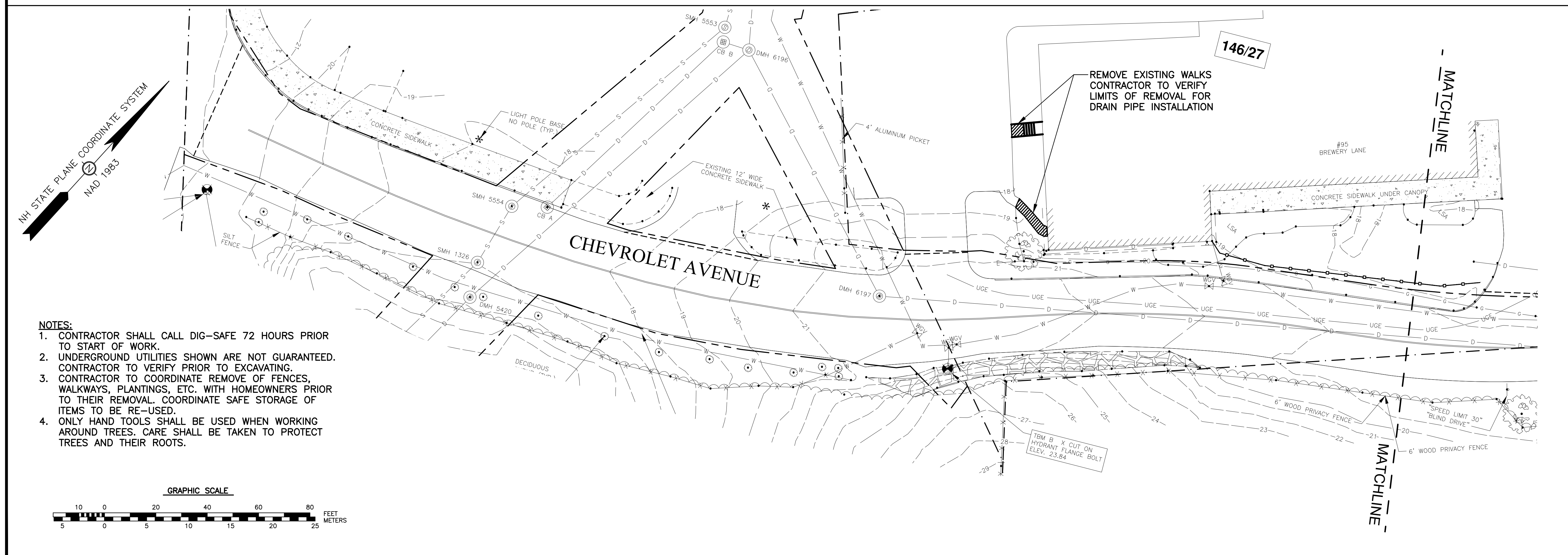
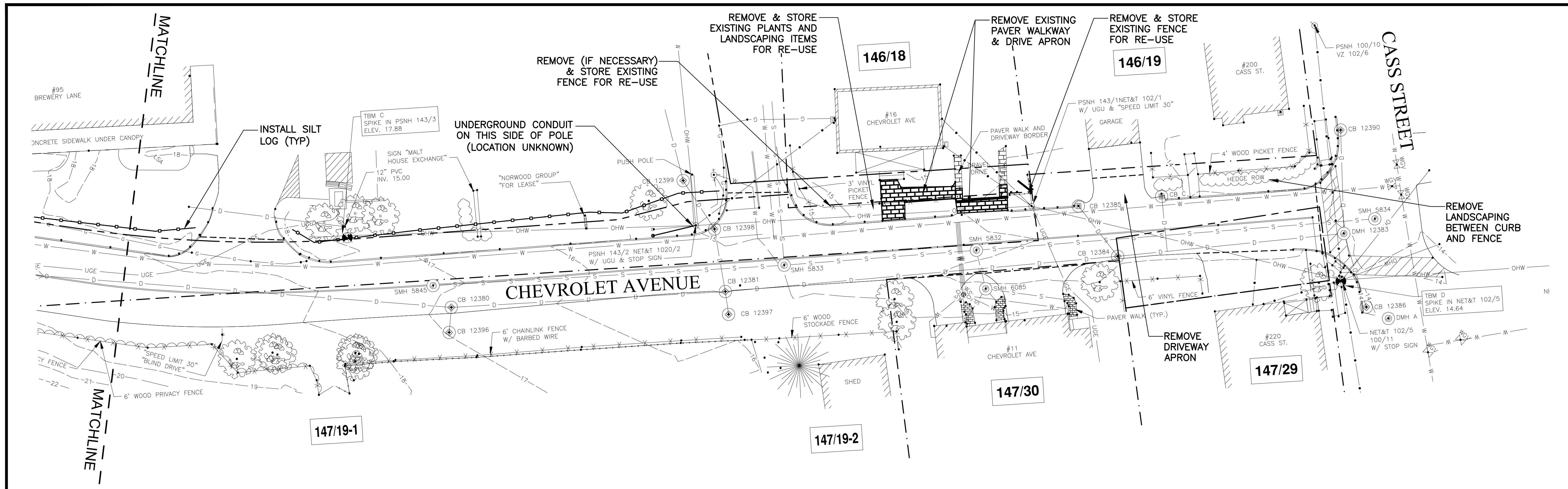

- NOTES:**
1. CONTRACTOR SHALL CALL DIG-SAFE 72 HOURS PRIOR TO START OF WORK.
  2. UNDERGROUND UTILITIES SHOWN ARE NOT GUARANTEED. CONTRACTOR TO VERIFY PRIOR TO EXCAVATING.
  3. CONTRACTOR TO COORDINATE REMOVE OF FENCES, WALKWAYS, PLANTINGS, ETC. WITH HOMEOWNERS PRIOR TO THEIR REMOVAL. COORDINATE SAFE STORAGE OF ITEMS TO BE RE-USED.
  4. ONLY HAND TOOLS SHALL BE USED WHEN WORKING AROUND TREES. CARE SHALL BE TAKEN TO PROTECT TREES AND THEIR ROOTS.

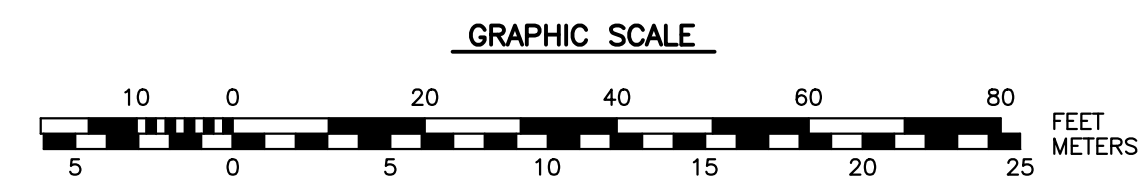

DATE: APRIL 2, 2020	SCALE: AS SHOWN
PROJECT NO.: COP-016	ENGINEER OF RECORD: MARC R. BATCHELDER, PE
FOR: City of Portsmouth Chevrolet Avenue Sidewalk	
<b>Seaport Engineering, LLC</b> PORTSMOUTH, NH (603) 498-8449 www.seaporteng.com	
TITLE: EXISTING CONDITIONS and DEMOLITION PLAN	
<b>C-101</b>	

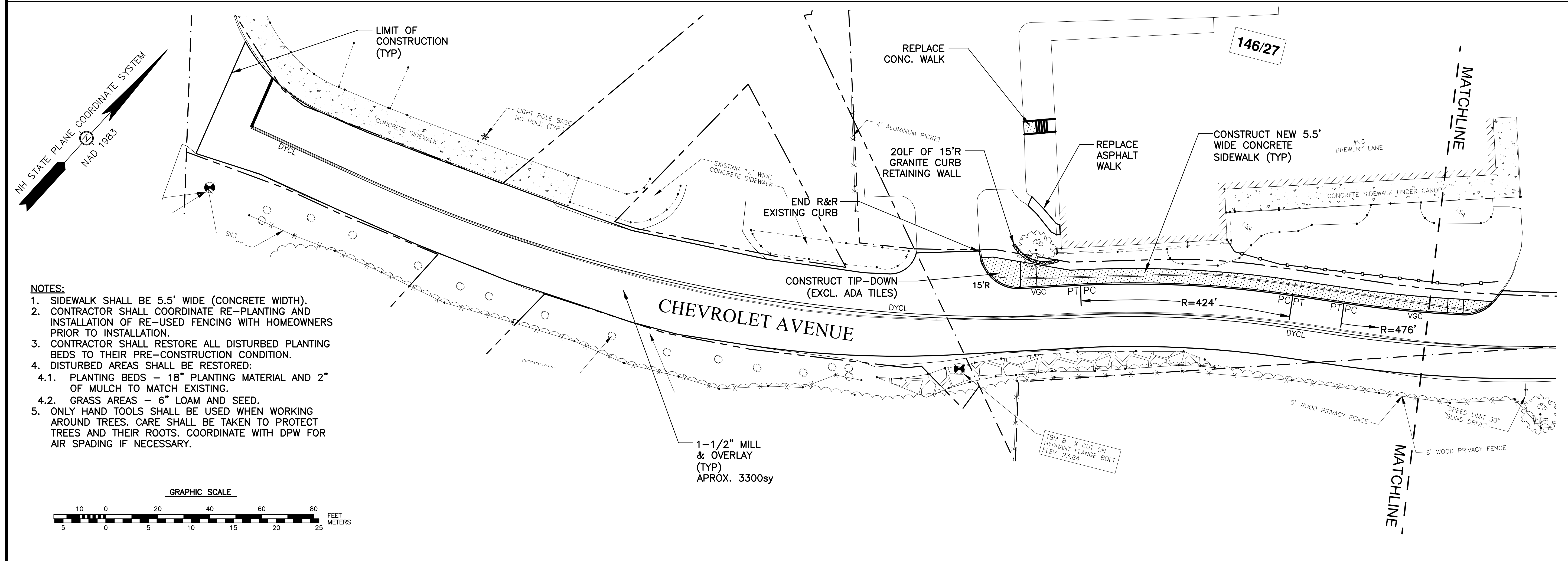
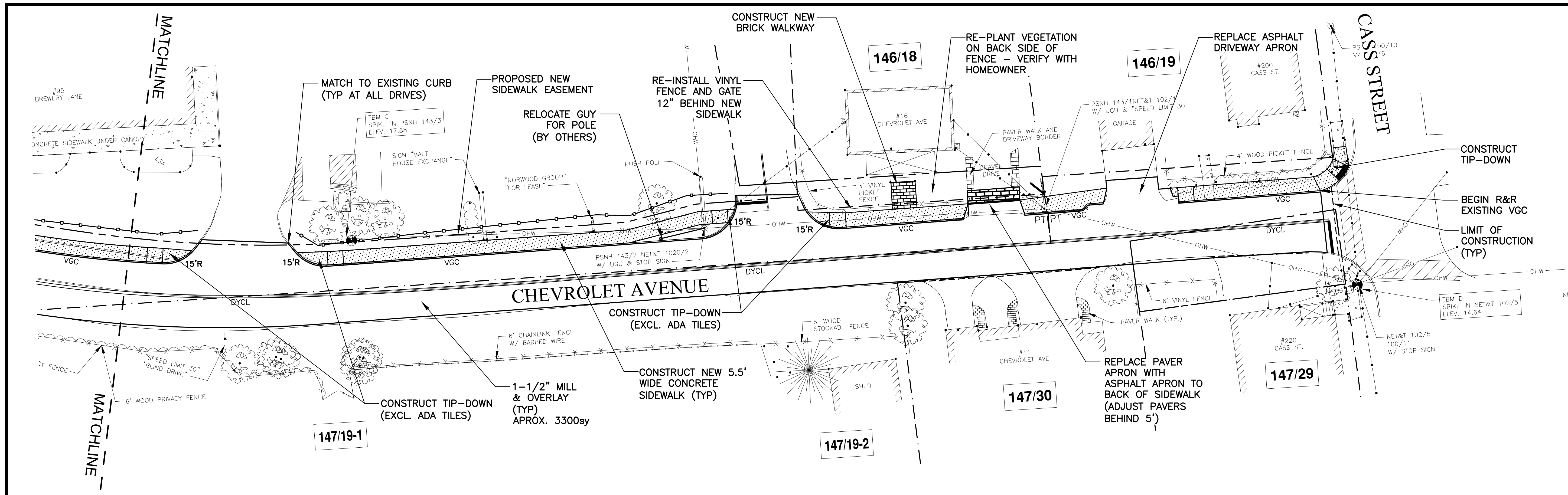

- NOTES:**
1. SIDEWALK SHALL BE 5.5' WIDE (CONCRETE WIDTH).
  2. CONTRACTOR SHALL COORDINATE RE-PLANTING AND INSTALLATION OF RE-USED FENCING WITH HOMEOWNERS PRIOR TO INSTALLATION.
  3. CONTRACTOR SHALL RESTORE ALL DISTURBED PLANTING BEDS TO THEIR PRE-CONSTRUCTION CONDITION.
  4. DISTURBED AREAS SHALL BE RESTORED:
    - 4.1. PLANTING BEDS - 18" PLANTING MATERIAL AND 2" OF MULCH TO MATCH EXISTING.
    - 4.2. GRASS AREAS - 6" LOAM AND SEED.
  5. ONLY HAND TOOLS SHALL BE USED WHEN WORKING AROUND TREES. CARE SHALL BE TAKEN TO PROTECT TREES AND THEIR ROOTS. COORDINATE WITH DPW FOR AIR SPADING IF NECESSARY.

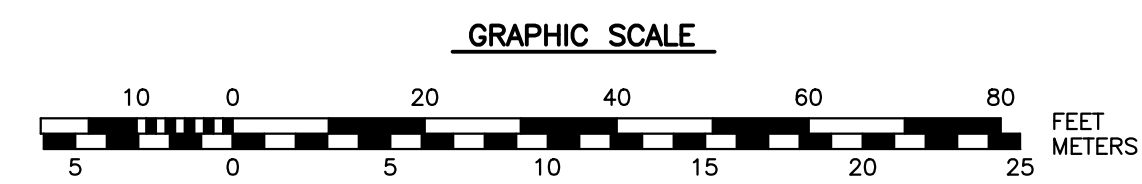

NO.	DESCRIPTION	DATE
0	ISSUED FOR CONSTRUCTION	05/06/21

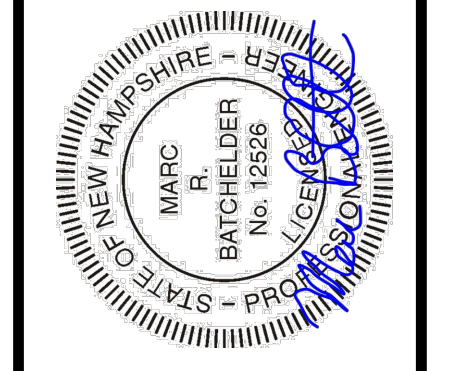

DATE: APRIL 2, 2020  
 SCALE: AS SHOWN  
 PROJECT NO.: COP-016  
 MARC R. BATCHELDER, PE  
 ENGINEER OF RECORD

FOR:  
 City of Portsmouth  
 Chevrolet Avenue  
 Sidewalk

**Seaport Engineering, LLC**  
 PORTSMOUTH, NH  
 (603) 498-8449  
 www.seaporteng.com

TITLE:  
**PROPOSED LAYOUT PLAN**  
 C-102



**PROJECT NAME AND LOCATION:**  
MCDONOUGH (PHASE 4) – ROADWAY IMPROVEMENTS  
PORTSMOUTH, NEW HAMPSHIRE

**DESCRIPTION:**  
THE PROJECT CONSISTS OF INSTALLATION OF NEW WATER MAIN FROM BREWSTER STREET TO BRIDGE STREET AND CORRESPONDING SIDE STREETS. REPLACEMENT OF DRAINAGE SYSTEM AND PORTIONS OF SEWER SYSTEM. RECLAIM THE EXISTING ASPHALT PAVEMENT SURFACE, RE-GRADE THE BASE MATERIALS AND RESURFACE ROADWAY. INCLUDES RECONSTRUCTION OF EXISTING CURBING AND SIDEWALKS.

- CONSTRUCTION SEQUENCE:**
1. INSTALL ALL EROSION CONTROL MEASURES.
  2. INSTALLATION OF SEWER, WATER AND DRAINAGE SYSTEMS.
  3. RECLAIM EXISTING ASPHALT PAVEMENT.
  4. GRADE AND COMPACT BASE MATERIALS.
  5. PLACE BASE COURSE OF ROADWAY PAVEMENT.
  6. RESET CURBING AND CONSTRUCT NEW SIDEWALKS.
  7. FINISH GRADE BEHIND SIDEWALKS.
  8. PLACE SEED AND MULCH ON LOAMED AREAS.
  9. PLACE WEARING COURSE OF PAVEMENT.
  10. INSTALL ALL ROADWAY STRIPING AND SIGNS.
  11. WHEN CONSTRUCTION ACTIVITY IS COMPLETE AND SITE IS STABILIZED, REMOVE EROSION CONTROL MEASURES.

**EROSION AND SEDIMENT CONTROLS AND STABILIZATION PRACTICES:**  
THE EROSION CONTROL PROCEDURES SHALL CONFORM TO SECTION 645 OF THE "STANDARD SPECIFICATION FOR ROAD AND BRIDGE CONSTRUCTION" OF THE NHDOT, AND "STORM WATER MANAGEMENT AND EROSION AND SEDIMENT CONTROL HANDBOOK FOR URBAN AND DEVELOPING AREAS IN NEW HAMPSHIRE".

DURING CONSTRUCTION AND THEREAFTER, EROSION CONTROL MEASURES ARE TO BE IMPLEMENTED AS NOTED. THE SMALLEST PRACTICAL AREA OF LAND SHOULD BE EXPOSED AT ANY ONE TIME DURING CONSTRUCTION, BUT IN NO CASE SHALL EXCEED 5 ACRES AT ANY ONE TIME BEFORE DISTURBED AREAS ARE STABILIZED.

- AN AREA SHALL BE CONSIDERED STABLE IF ONE OF THE FOLLOWING HAS OCCURRED:
- BASE COURSE GRAVELS HAVE BEEN INSTALLED IN AREAS TO BE PAVED;
  - A MINIMUM OF 85% VEGETATED GROWTH HAS BEEN ESTABLISHED;
  - A MINIMUM OF 3" OF NON-EROSIVE MATERIAL SUCH AS STONE OR RIPRAP HAS BEEN INSTALLED; OR
  - EROSION CONTROL BLANKETS HAVE BEEN PROPERLY INSTALLED.

ANY DISTURBED AREAS WHICH ARE TO BE LEFT TEMPORARILY, AND WHICH WILL BE REGRADED LATER DURING CONSTRUCTION SHALL BE MACHINE HAY MULCHED AND SEEDED WITH RYE GRASS TO PREVENT EROSION.

DUST CONTROL: IF TEMPORARY STABILIZATION PRACTICES, SUCH AS TEMPORARY VEGETATION AND MULCHING, DO NOT ADEQUATELY REDUCE DUST GENERATION, APPLICATION OF WATER OR CALCIUM CHLORIDE SHALL BE APPLIED IN ACCORDANCE WITH BEST MANAGEMENT PRACTICES.

ALL EROSION CONTROLS SHALL BE INSPECTED WEEKLY DURING THE LIFE OF THE PROJECT AND AFTER EACH STORM OF 0.5" OR GREATER. ALL DAMAGED SILT FENCES SHALL BE REPAIRED. SEDIMENT DEPOSITS SHALL PERIODICALLY BE REMOVED AND DISPOSED IN A SECURED LOCATION.

AVOID THE USE OF FUTURE OPEN SPACES (LOAM AND SEED AREAS) WHEREVER POSSIBLE DURING CONSTRUCTION. CONSTRUCTION TRAFFIC SHALL USE THE ROADBEDS OF FUTURE ACCESS DRIVES AND PARKING AREAS.

TOPSOIL REQUIRED FOR THE ESTABLISHMENT OF VEGETATION SHALL BE STOCKPILED IN AMOUNTS NECESSARY TO COMPLETE FINISHED GRADING OF ALL EXPOSED AREAS. CONSTRUCT SILT FENCE AROUND TOPSOIL STOCKPILE.

ALL FILLS SHALL BE PLACED AND COMPACTED TO REDUCE EROSION, SLIPPAGE, SETTLEMENT, SUBSIDENCE OR OTHER RELATED PROBLEMS.

DISTURBED AREAS SHALL BE SEEDED WITHIN 72 HOURS FOLLOWING FINISHED GRADING.

AT NO TIME SHALL ANY DISTURBED AREA REMAIN UNSTABILIZED FOR LONGER THAN 72 HOURS. ALL AREAS WHERE CONSTRUCTION IS NOT COMPLETE WITHIN THIRTY DAYS OF THE INITIAL DISTURBANCE SHALL BE MACHINE HAY MULCHED AND SEEDED WITH RYE GRASS TO PREVENT EROSION.

**INSTALLATION PROCEDURES OF EROSION AND SEDIMENT CONTROLS:**

- A. VEGETATIVE PRACTICE**
- FOR PERMANENT MEASURES AND PLANTINGS FROM EARLY SPRING TO SEPTEMBER 30:
- LIMESTONE SHALL BE THOROUGHLY INCORPORATED INTO THE LOAM LAYER AT A RATE OF 2 TONS PER ACRE.
- FERTILIZER SHALL BE SPREAD ON THE TOP LAYER OF LOAM AND WORKED INTO THE SURFACE. FERTILIZER APPLICATION RATE SHALL BE 500 POUNDS PER ACRE OF 10-20-20 FERTILIZER.
- SEED SHALL BE SOWN AT THE RATES SHOWN IN THE TABLE BELOW. IMMEDIATELY BEFORE SEEDING, THE SOIL SHALL BE LIGHTLY RAKED. ONE HALF THE SEED SHALL BE SOWN IN ONE DIRECTION AND THE OTHER HALF AT RIGHT ANGLES TO THE ORIGINAL DIRECTION. IT SHALL BE LIGHTLY RAKED INTO THE SOIL TO A DEPTH NOT OVER 1/4 INCH AND ROLLED WITH A HAND ROLLER WEIGHING NOT OVER 100 POUNDS PER LINEAR FOOT OF WIDTH. HAY MULCH SHALL BE APPLIED IMMEDIATELY AFTER SEEDING AT A RATE OF 1.5 TO 2 TONS PER ACRE, AND SHALL BE HELD IN PLACE USING APPROPRIATE TECHNIQUES FROM THE EROSION AND SEDIMENT CONTROL HANDBOOK.
- THE SURFACE SHALL BE WATERED AND KEPT MOIST WITH A FINE SPRAY AS REQUIRED, WITHOUT WASHING AWAY THE SOIL, UNTIL THE GRASS IS WELL ESTABLISHED. ANY AREAS WHICH ARE NOT SATISFACTORILY COVERED SHALL BE RESEEDED, AND ALL NOXIOUS WEEDS REMOVED.

A GRASS SEED MIXTURE CONTAINING THE FOLLOWING SEED REQUIREMENTS SHALL BE:

GENERAL COVER	SEEDING RATE
CREeping RED FESCUE	100 LBS/ACRE
KENTUCKY BLUEGRASS	100 LBS/ACRE
<b>SLOPE SEED (ALL SLOPES GREATER THAN OR EQUAL TO 3:1)</b>	
CREeping RED FESCUE	20 LBS/ACRE
TALL FESCUE	20 LBS/ACRE
BIRDSFOOT TREFOIL	2 LBS/ACRE

IN NO CASE SHALL THE WEED CONTENT EXCEED ONE PERCENT BY WEIGHT. ALL SEED SHALL COMPLY WITH APPLICABLE STATE AND FEDERAL SEED LAWS.

FOR TEMPORARY PROTECTION OF DISTURBED AREAS: MULCHING AND SEEDING SHALL BE APPLIED AT THE FOLLOWING RATES:

PERENNIAL RYE:	0.7 LBS/1,000 S.F.
MULCH:	1.5 TONS/ACRE

- B. MULCHING**
- IN ORDER TO BE EFFECTIVE, MULCHING MUST BE IN PLACE PRIOR TO MAJOR STORM EVENTS. THERE ARE TWO TYPES OF STANDARDS: APPLY MULCH PRIOR TO ANY STORM EVENT: THIS IS APPLICABLE WHEN WORKING WITHIN 100 FEET OF WETLANDS. IT WILL BE NECESSARY TO CLOSELY MONITOR WEATHER FORECASTS FOR ADEQUATE WARNING TO SIGNIFICANT STORMS. REQUIRED MULCHING WITHIN SPECIFIED TIME PERIOD: THE TIME PERIOD CAN RANGE FROM 14 TO 21 DAYS OF INACTIVITY IN AN AREA, THE LENGTH OF TIME VARYING WITH SITE CONDITIONS. JUDGEMENT SHALL BE USED TO EVALUATE THE INTERACTION OF SITE CONDITIONS AND THE POTENTIAL FOR IMPACT ON ADJACENT AREAS TO CHOOSE AN APPROPRIATE TIME RESTRICTION.
- WHEN MULCH IS TO BE APPLIED TO PROVIDE PROTECTION OVER WINTER MONTHS, IT SHALL BE AT A RATE OF 6,000 POUNDS OF HAY OR STRAW PER ACRE. A TACKIFIER SHALL BE ADDED TO THE MULCH.
- C. WINTER NOTES**
- ALL PROPOSED VEGETATED AREAS WHICH DO NOT EXHIBIT A MINIMUM OF 85% VEGETATIVE GROWTH BY OCTOBER 15TH, OR WHICH ARE DISTURBED AFTER OCTOBER 15TH, SHALL BE STABILIZED BY SEEDING AND INSTALLING EROSION CONTROL BLANKETS ON SLOPES GREATER THAN 3:1, AND SEEDING AND PLACING 3 TO 4 TONS OF MULCH PER ACRE, SECURED WITH ANCHORED NETTING, ELSEWHERE. THE INSTALLATION OF EROSION CONTROL BLANKETS OR MULCH AND NETTING SHALL NOT OCCUR OVER ACCUMULATED SNOW OR ON FROZEN GROUND AND SHALL BE COMPLETED IN ADVANCE OF THAW OR SPRING MELT EVENTS.

ALL DITCHES OR SWALES WHICH DO NOT EXHIBIT A MINIMUM OF 85% VEGETATIVE GROWTH BY OCTOBER 15TH, OR WHICH ARE DISTURBED AFTER OCTOBER 15TH, SHALL BE STABILIZED TEMPORARILY WITH STONE OR EROSION CONTROL BLANKETS APPROPRIATE FOR THE DESIGN FLOW CONDITIONS.

AFTER NOVEMBER 15TH, INCOMPLETE ROAD OR PARKING SURFACES, WHERE WORK HAS STOPPED FOR THE WINTER SEASON, SHALL BE PROTECTED WITH A MINIMUM OF 3 INCHES OF CRUSHED GRAVEL PER NHDOT ITEM 304.3.

- MAINTENANCE AND PROTECTION:**
1. THE CONTRACTOR SHALL MAINTAIN ALL LOAM & SEED AREAS UNTIL FINAL ACCEPTANCE AT THE COMPLETION OF THE CONTRACT. MAINTENANCE SHALL INCLUDE WATERING, WEEDING, REMOVAL OF STONES AND OTHER FOREIGN OBJECTS OVER 1/2 INCHES IN DIAMETER WHICH MAY APPEAR AND THE FIRST TWO (2) CUTTINGS OF GRASS NO CLOSER THEN TEN (10) DAYS APART. THE FIRST CUTTING SHALL BE ACCOMPLISHED WHEN THE GRASS IS FROM 2 1/2 TO 3 INCHES HIGH. ALL BARE AND DEAD SPOTS WHICH BECOME APPARENT SHALL BE PROPERLY PREPARED, LIMED AND FERTILIZED, AND RESEEDED BY THE CONTRACTOR AT HIS EXPENSE AS MANY TIMES AS NECESSARY TO SECURE GOOD GROWTH. THE ENTIRE AREA SHALL BE MAINTAINED, WATERED AND CUT UNTIL ACCEPTANCE OF THE LAWN BY THE OWNER'S REPRESENTATIVE.
  2. THE CONTRACTOR SHALL TAKE WHATEVER MEASURES ARE NECESSARY TO PROTECT THE GRASS WHILE IT IS DEVELOPING.
  3. TO BE ACCEPTABLE, SEEDED AREAS SHALL CONSIST OF A UNIFORM STAND OF AT LEAST 90 PERCENT ESTABLISHED PERMANENT GRASS SPECIES, WITH UNIFORM COUNT OF AT LEAST 100 PLANTS PER SQUARE FOOT.
  4. SEEDED AREAS WILL BE FERTILIZED AND RESEEDED AS NECESSARY TO INSURE VEGETATIVE ESTABLISHMENT.
  5. THE SWALES WILL BE CHECKED WEEKLY AND REPAIRED WHEN NECESSARY UNTIL ADEQUATE VEGETATION IS ESTABLISHED.
  6. THE SILT FENCE BARRIER SHALL BE CHECKED AFTER EACH RAINFALL AND AT LEAST DAILY DURING PROLONGED RAINFALL.
  7. SILT FENCING SHALL BE REMOVED ONCE VEGETATION IS ESTABLISHED, AND DISTURBED AREAS RESULTING FROM SILT FENCE REMOVAL SHALL BE PERMANENTLY SEEDED.

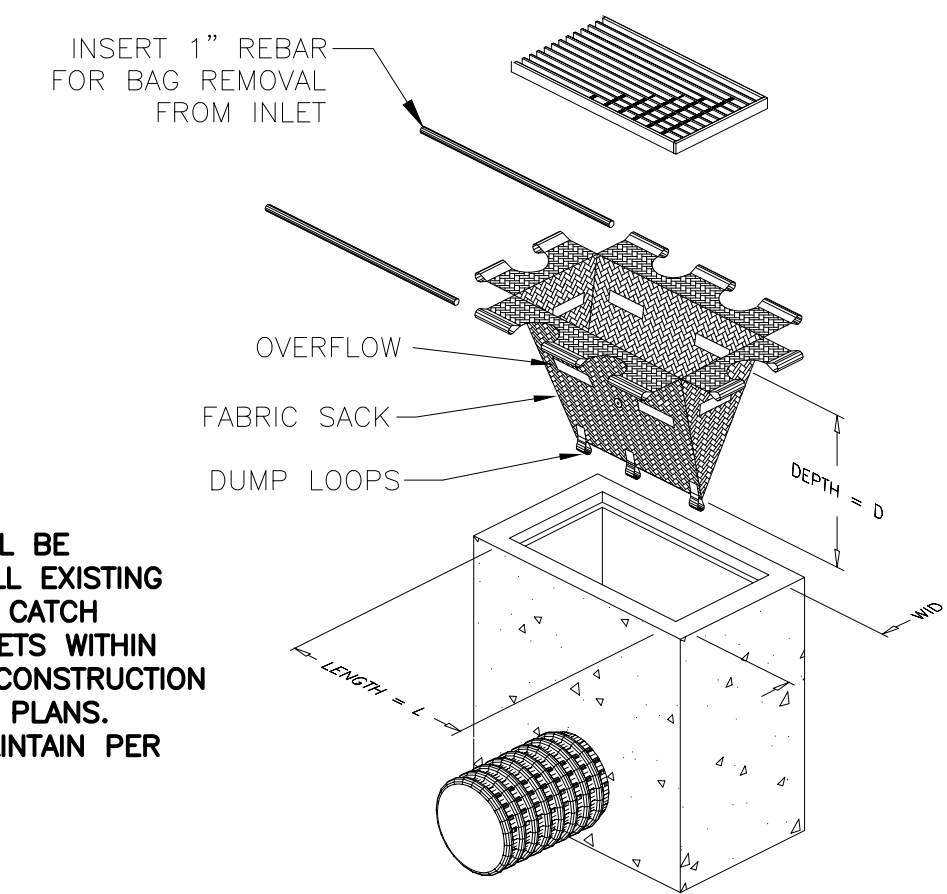

- NOTES:**
1. SILT SACK SHALL BE INSTALLED AT ALL EXISTING AND PROPOSED CATCH BASINS AND INLETS WITHIN THE LIMITS OF CONSTRUCTION SHOWN ON THE PLANS.
  2. INSTALL AND MAINTAIN PER MANUFACTURERS REQUIREMENTS.

**DRAINAGE INLET PROTECTION**  
SCALE: N.T.S.

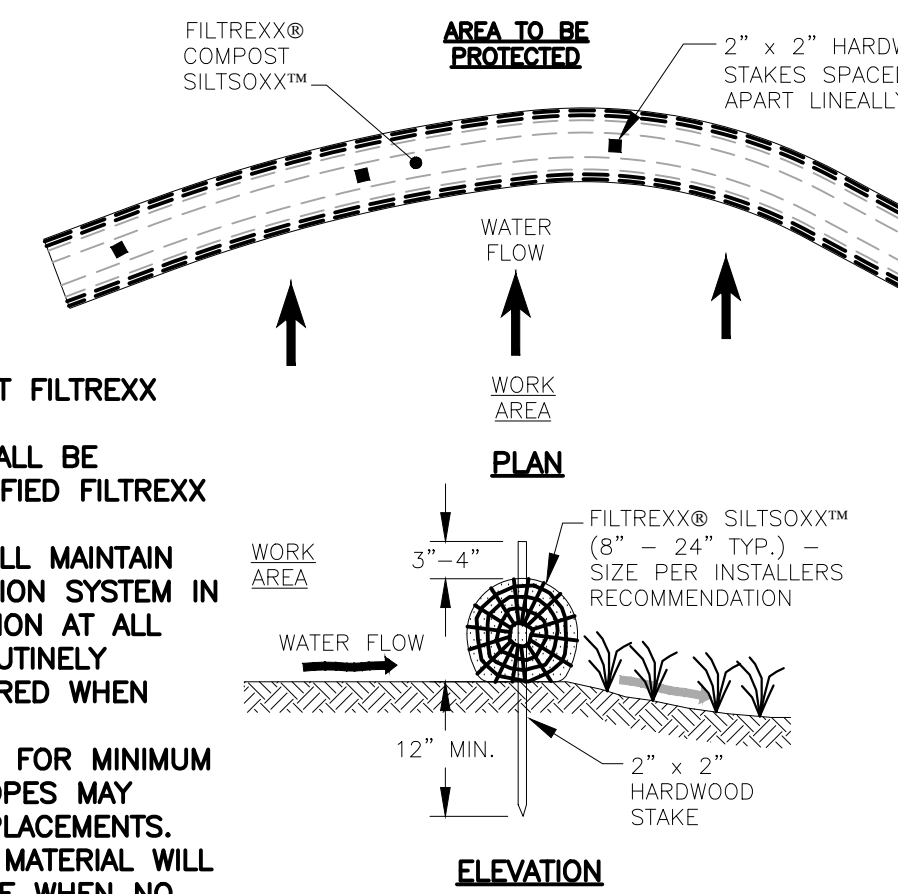

- NOTES:**
1. ALL MATERIAL TO MEET FILTREXX SPECIFICATIONS.
  2. FILTREXX SYSTEM SHALL BE INSTALLED BY A CERTIFIED FILTREXX INSTALLER.
  3. THE CONTRACTOR SHALL MAINTAIN THE COMPOST FILTRATION SYSTEM IN A FUNCTIONAL CONDITION AT ALL TIMES. IT WILL BE ROUTINELY INSPECTED AND REPAIRED WHEN REQUIRED.
  4. SILT SOXX DEPICTED IS FOR MINIMUM SLOPES, GREATER SLOPES MAY REQUIRE ADDITIONAL PLACEMENTS.
  5. THE COMPOST FILTER MATERIAL WILL BE DISPERSED ON SITE WHEN NO LONGER REQUIRED, AS DETERMINED BY THE ENGINEER.

**SEDIMENTATION LOG**  
SCALE: N.T.S.

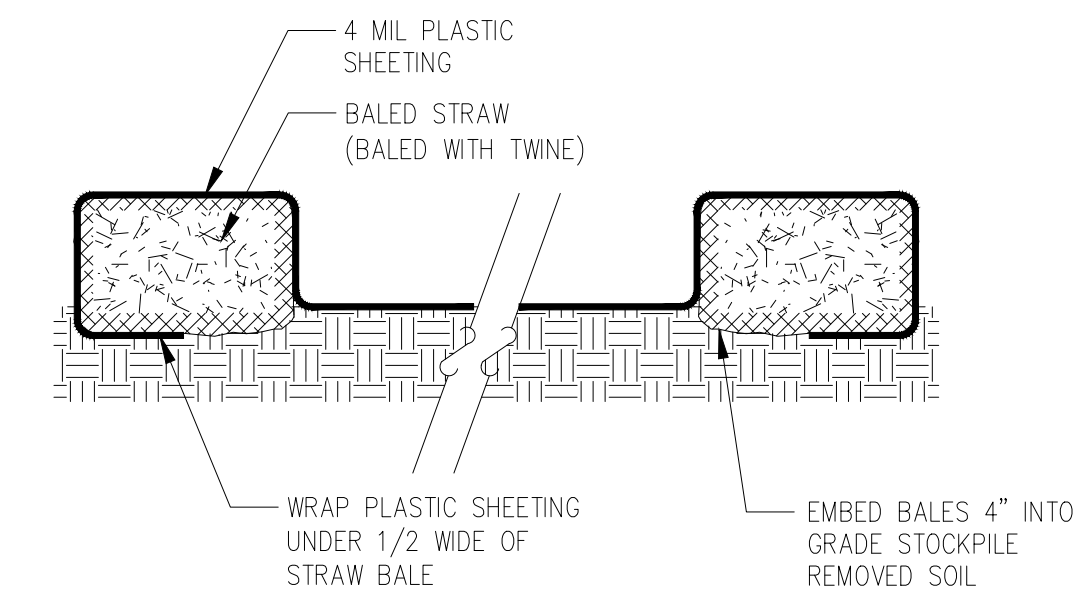

- NOTES:**
1. CONTRACTOR MUST PROVIDE A CONCRETE CLEAN-OUT STATION. NO TRUCK CLEAN-OUT WILL BE ALLOWED WITHOUT CONTAINMENT.
  2. PLASTIC WRAP SHALL BE FREE OF TEARS OR HOLES.
  3. AFTER BASIN IS USED, WASHWATER FROM WASHOUT BASIN SHALL BE ALLOWED TO EVAPORATE OR BE VACUUMED OUT.
  4. REMOVE REMAINING HARDENED SOLIDS.
  5. REPLACE PLASTIC SHEETING AND TRAWBALES AS REQUIRED.

**CONCRETE CLEAN-OUT**  
SCALE: N.T.S.

NO.	DESCRIPTION	DATE
0	ISSUED FOR CONSTRUCTION	05/06/21
	MRB	APPD

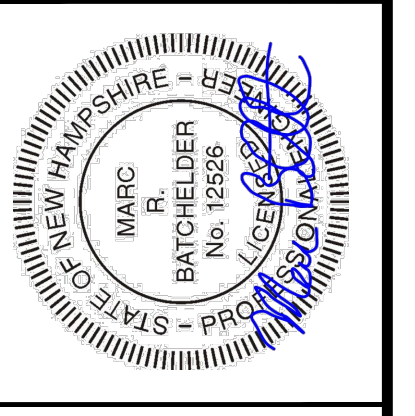

DATE: APRIL 2, 2020  
SCALE: AS SHOWN  
PROJECT NO.: COP-016  
MARC R. BATCHELDER, PE  
ENGINEER OF RECORD

FOR: City of Portsmouth  
Chevrolet Avenue  
Sidewalk

**Seaport Engineering, LLC**  
PORTSMOUTH, NH  
(603) 498-8449  
www.seaporteng.com

TITLE: EROSION CONTROLS NOTES & DETAILS

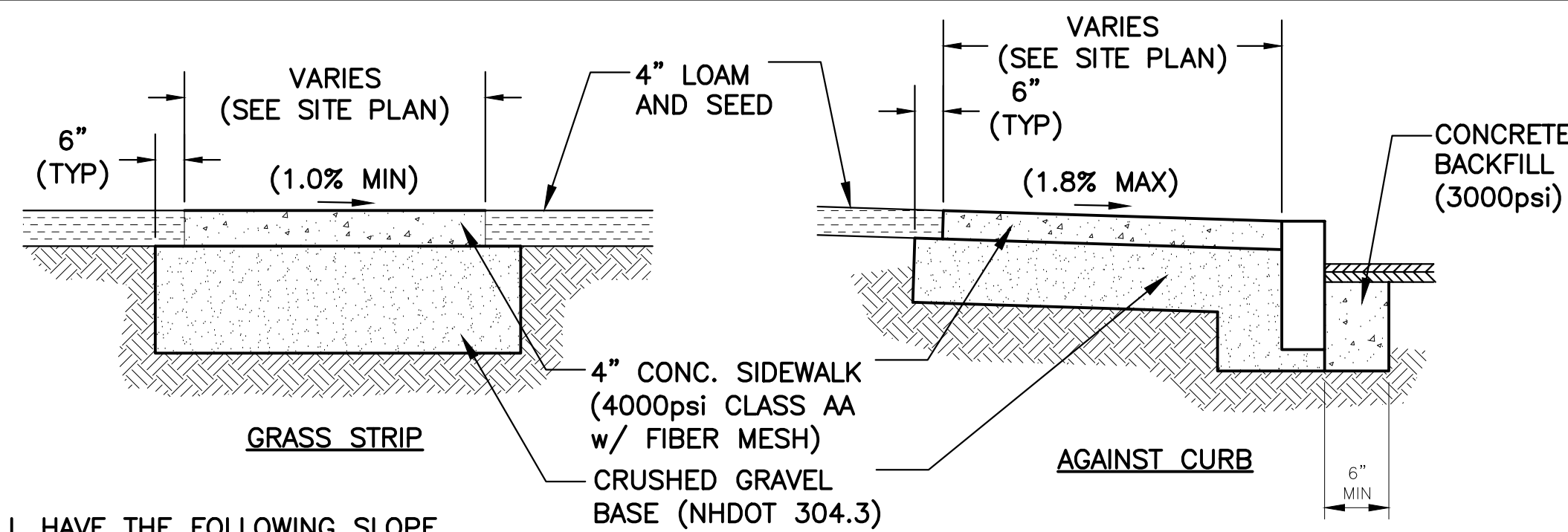

- NOTES:**
- SIDEWALKS SHALL HAVE THE FOLLOWING SLOPE REQUIREMENTS:
    - CROSS SLOPE - 1.5% PREFERRED (1.0% MIN. & 1.8% MAX.).
    - RUNNING SLOPE - 4.5% MAX. (UNLESS AT TIP-DOWNS OR MATCHING STREET PITCH)
  - MEDIUM BROOM FINISH.
  - 6x6~W2.9xW2.9 W.W.F. TO BE USED AT ALL ACCESSIBLE RAMPS.
  - JOINTS SHALL BE HAND TOOLED w/ 1/8" RADII.
  - EXPANSION JOINT FIBER FILLER SHALL BE TRIMMED TO 1/4" BELOW SIDEWALK SURFACE FOR SEALANT.
  - THERE SHALL BE NO CHANGE IN ELEVATION (LIP) OR GAPS IN THE SIDEWALK GREATER THAN 1/4".
  - SIDEWALK CONCRETE SHALL BE TREATED WITH SILOXANE SEALER AFTER 30-DAY CURE.
  - CONTRACTOR IS RESPONSIBLE TO CONSTRUCT PER ADA STANDARDS. CONTRACTOR SHALL USE SMART LEVEL TO VERIFY SLOPES.

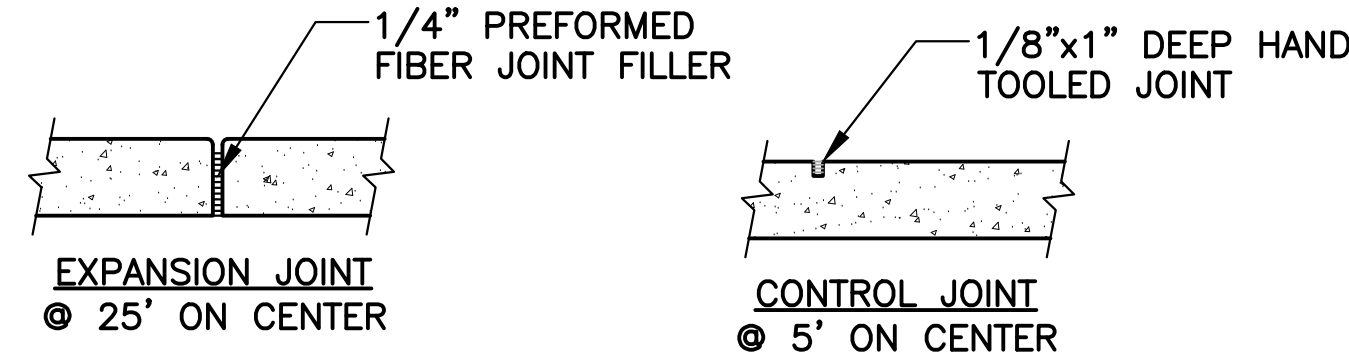

**CONCRETE SIDEWALK**  
SCALE: N.T.S.

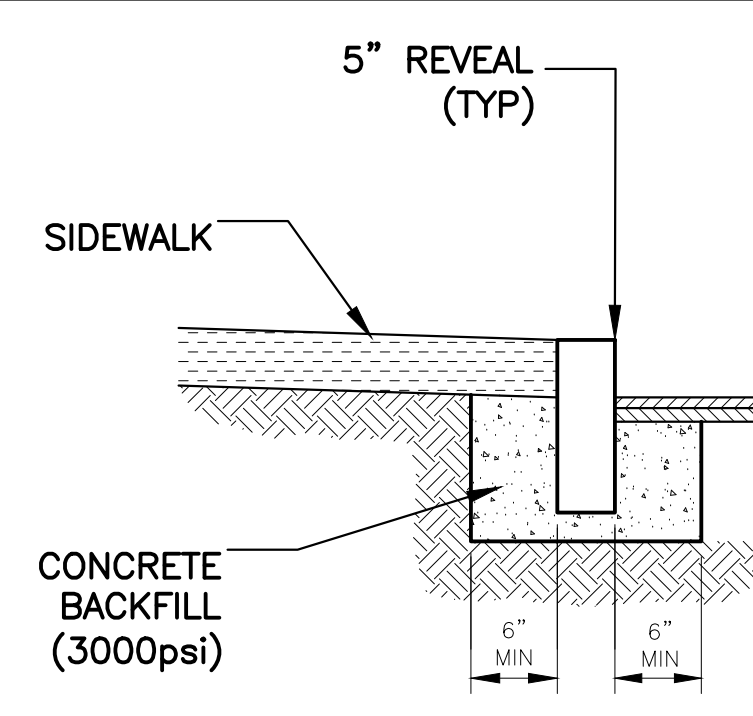

RADIUS	MAX. LENGTH
<20'	USE CURVED CURB
21'-25'	3'
26'-30'	4'
31'-35'	5'
36'-40'	6'
41'-50'	7'
51'-56'	8'
56'-60'	9'
OVER 60'	10'

- NOTES:**
- CURB TO BE SET TO LINE AND GRADE SPECIFIED.
  - ALL RADII 20 FEET AND SMALLER SHALL USE CURVED SECTIONS.
  - CURB AT FLUSH SECTION OF SIDEWALK SHALL BE SET TO 1.5% (2.0% MAX.) SLOPE. CURB AT RAMPS SHALL BE SET TO 8.0% (8.3% MAX.). IT IS THE CURB CONTRACTORS RESPONSIBILITY TO VERIFY SLOPES WITH A SMART LEVEL.
  - VERTICAL GRANITE JOINTS SHALL BE MORTARED.
  - SEE CHART FOR MAX / MIN STONE LENGTHS.
  - RESET EXISTING CURB. ANY MISSING OR DAMAGED CURB SHALL BE REPLACED WITH MATCHING CURB SIZE.
  - NO CURB LESS THAN 3' IN LENGTH WILL BE ALLOWED.
  - CURB MATERIAL SHALL BE FROM THE SAME LOT OF GRANITE. VARIANCES IN COLOR AND TYPE WILL NOT BE ACCEPTED.

**VERTICAL GRANITE CURB**  
SCALE: N.T.S.

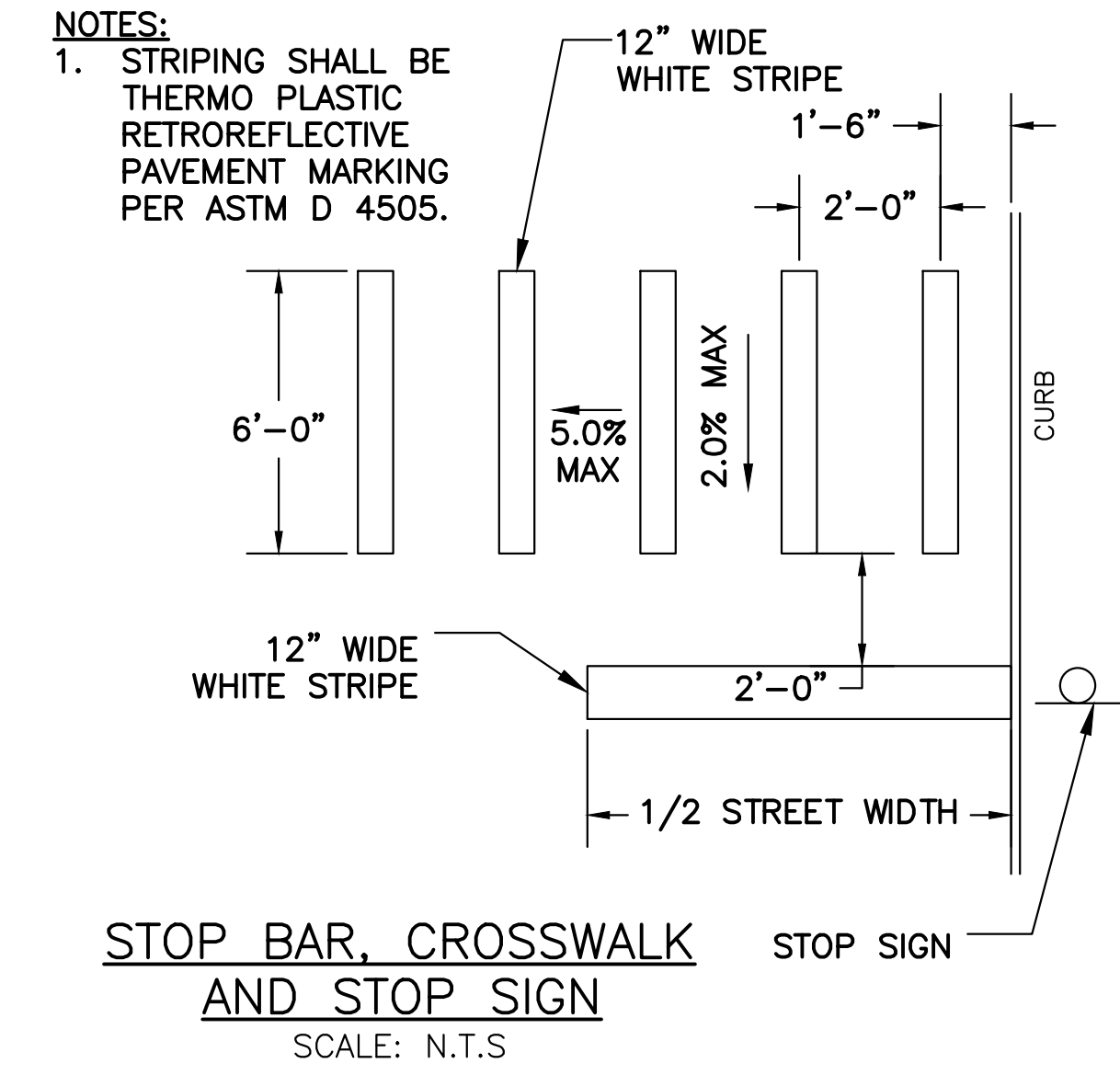

**STOP BAR, CROSSWALK AND STOP SIGN**  
SCALE: N.T.S.

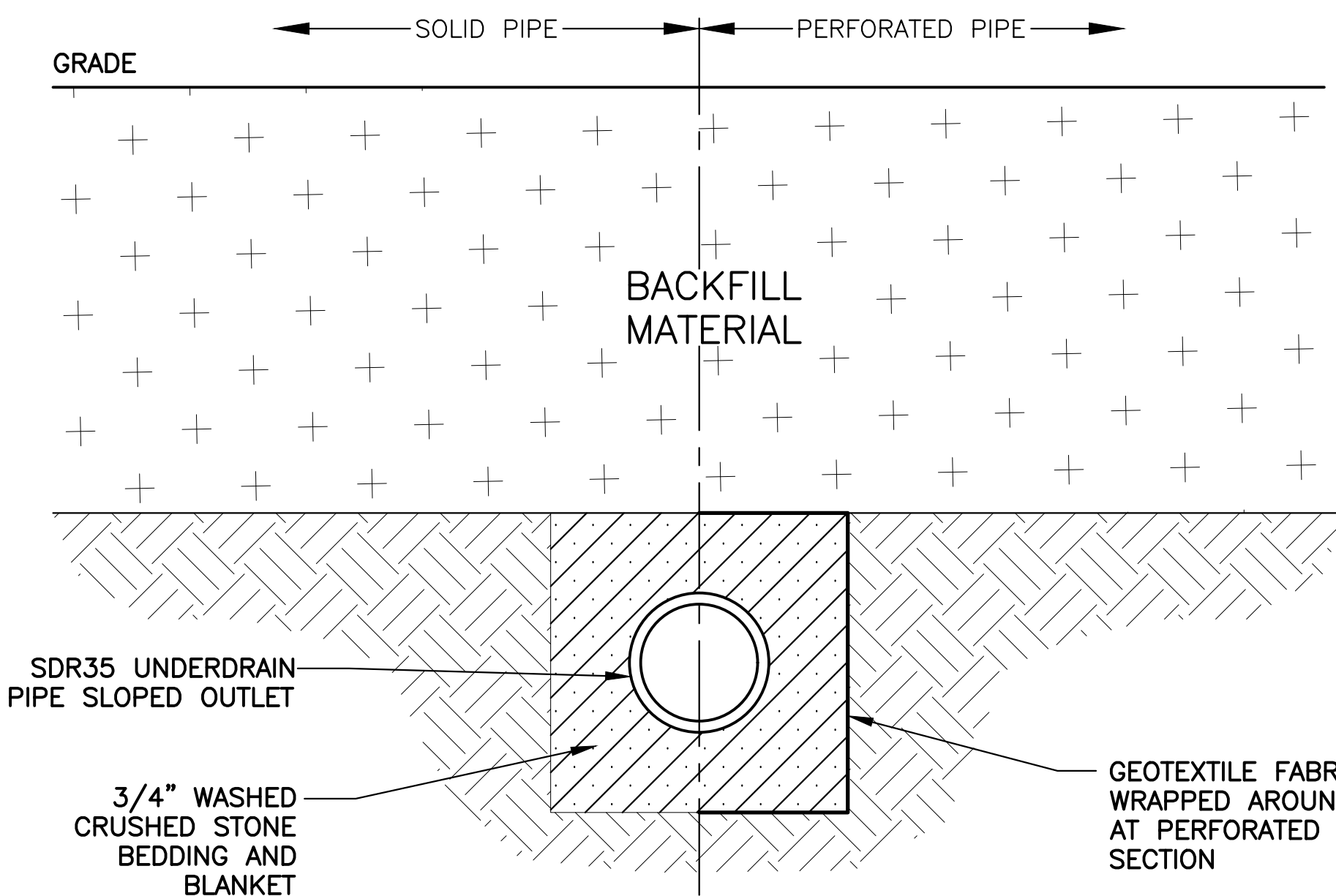

- NOTES:**
- GEOTEXTILE FABRIC SHALL BE MIRAFI 140N OR APPROVED EQUAL. FABRIC SHALL BE WRAPPED COMPLETELY AROUND STONE w/ 12" (MIN) OVERLAP AT SEAMS.
  - PERFORATION PATTERN SHALL BE 3 @ 120" APART. PIPE SET FOR PERFORATIONS AT 12, 4 and 8 O'CLOCK TO ALLOW FOR FLOW LINE, SUBMIT PATTERN FOR APPROVAL.
  - CRUSHED STONE SHALL BE A MINIMUM OF 6" ON ALL SIDES OF PIPE. CONTRACTOR SHALL VERIFY ALL EXISTING INVERT ELEVATIONS TO BE CONNECTED TO DRAIN PRIOR TO INSTALLATION OF UNDERDRAIN.
  - UNDERDRAIN TO BE DAY-LIGHTED AS SHOWN ON PLANS. OUTLET SHALL HAVE GEOTEXTILE FABRIC BELOW 12" THICK RIP-RAP APRON.
  - A RIPLEY DAM SHALL BE PLACED AT THE SOLID PIPE WHERE IT CONNECTS TO THE PERFORATED PIPE TO PREVENT GROUNDWATER CONTINUING THROUGH THE STONE BEDDING TO THE OUTLET.

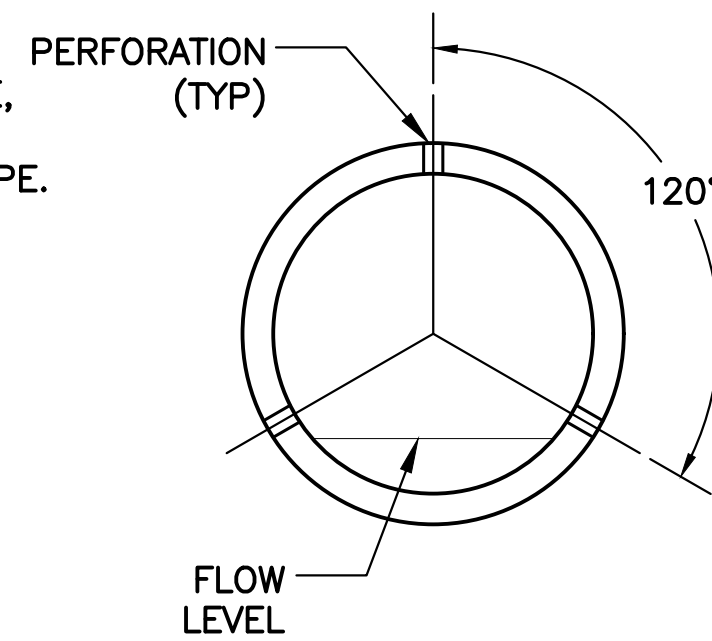

**UNDERDRAIN DETAIL**  
SCALE: N.T.S.

**PIPE PERFORATION & PLACEMENT**

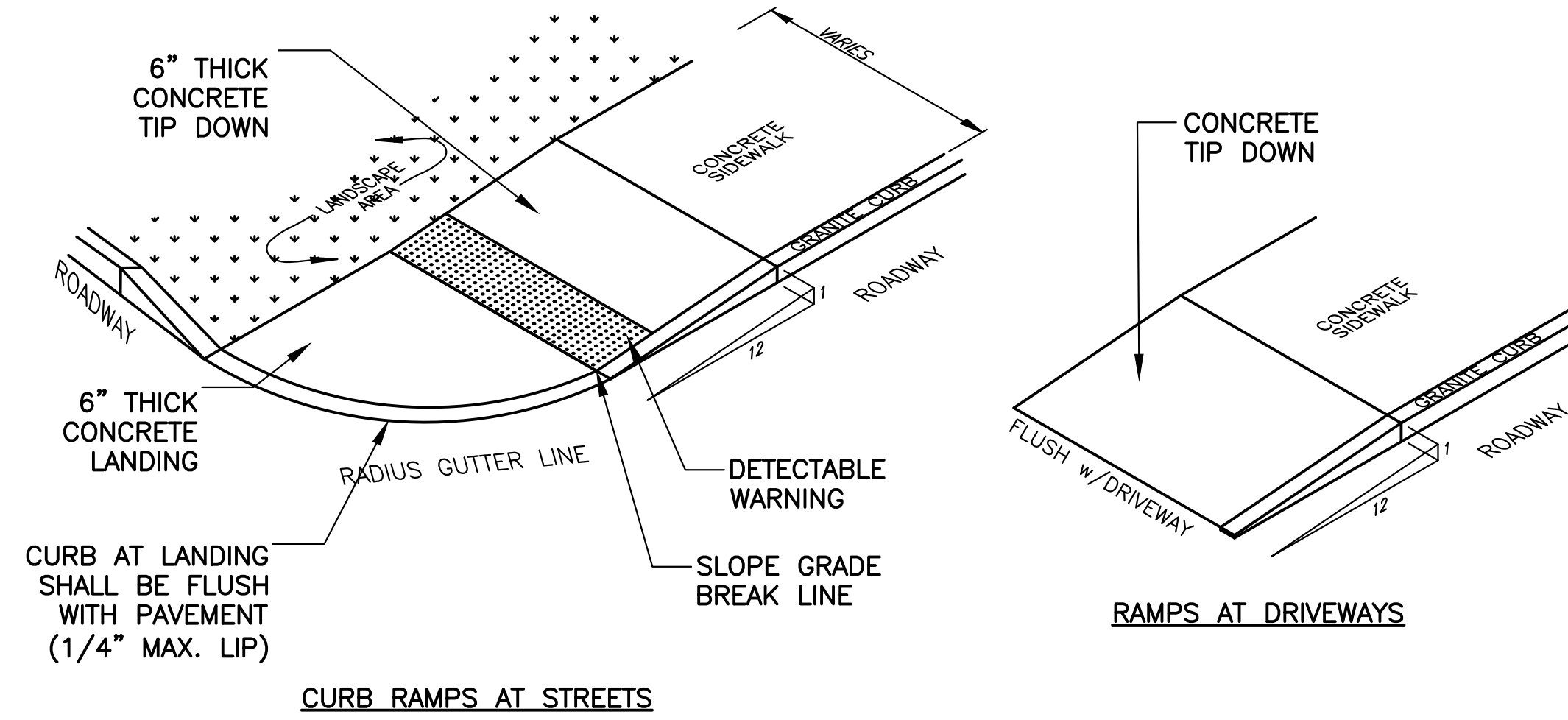

**CURB RAMPS AT STREETS**

**RAMPS AT DRIVEWAYS**

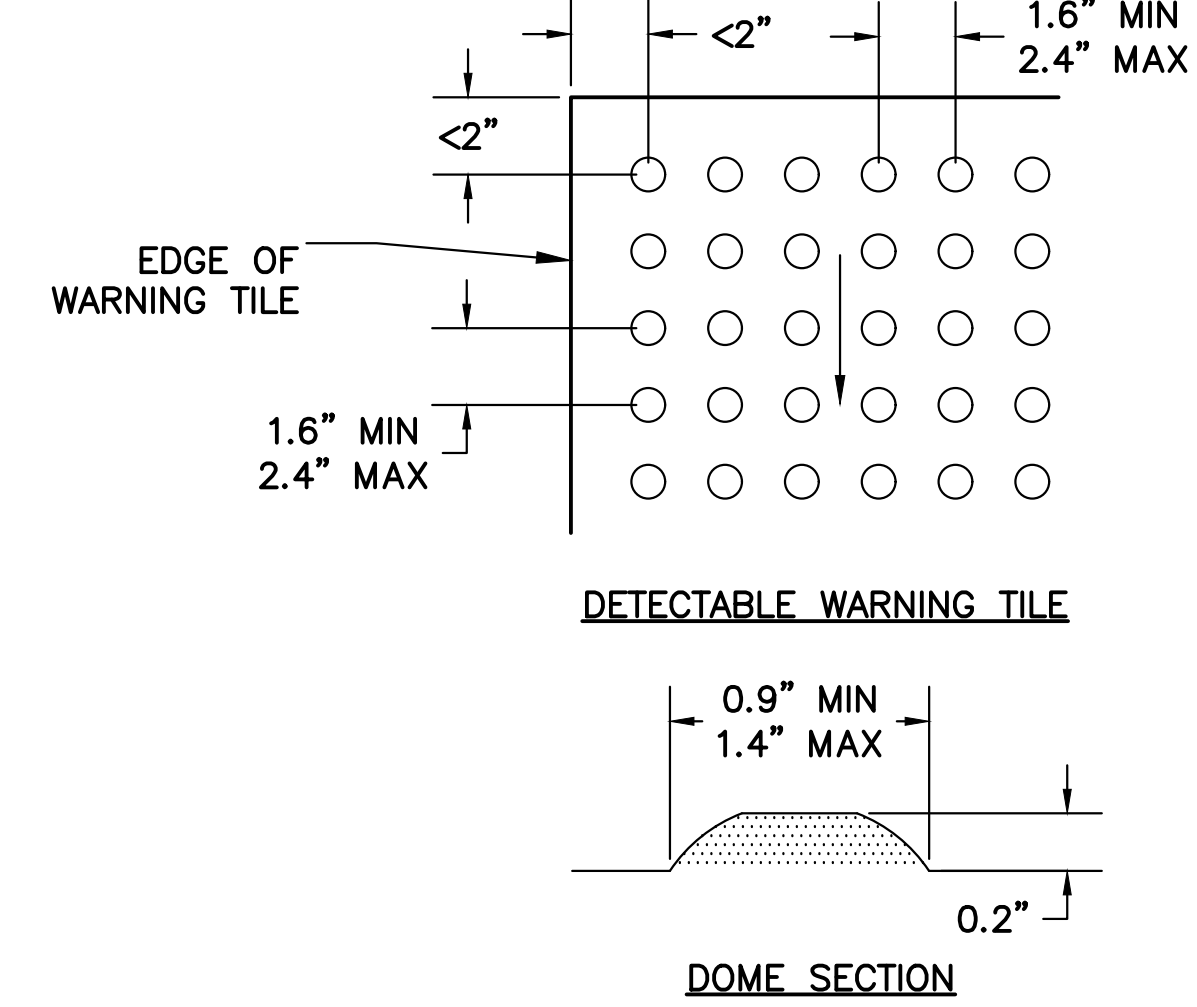

**DETECTABLE WARNING TILE**

**DOMES SECTION**

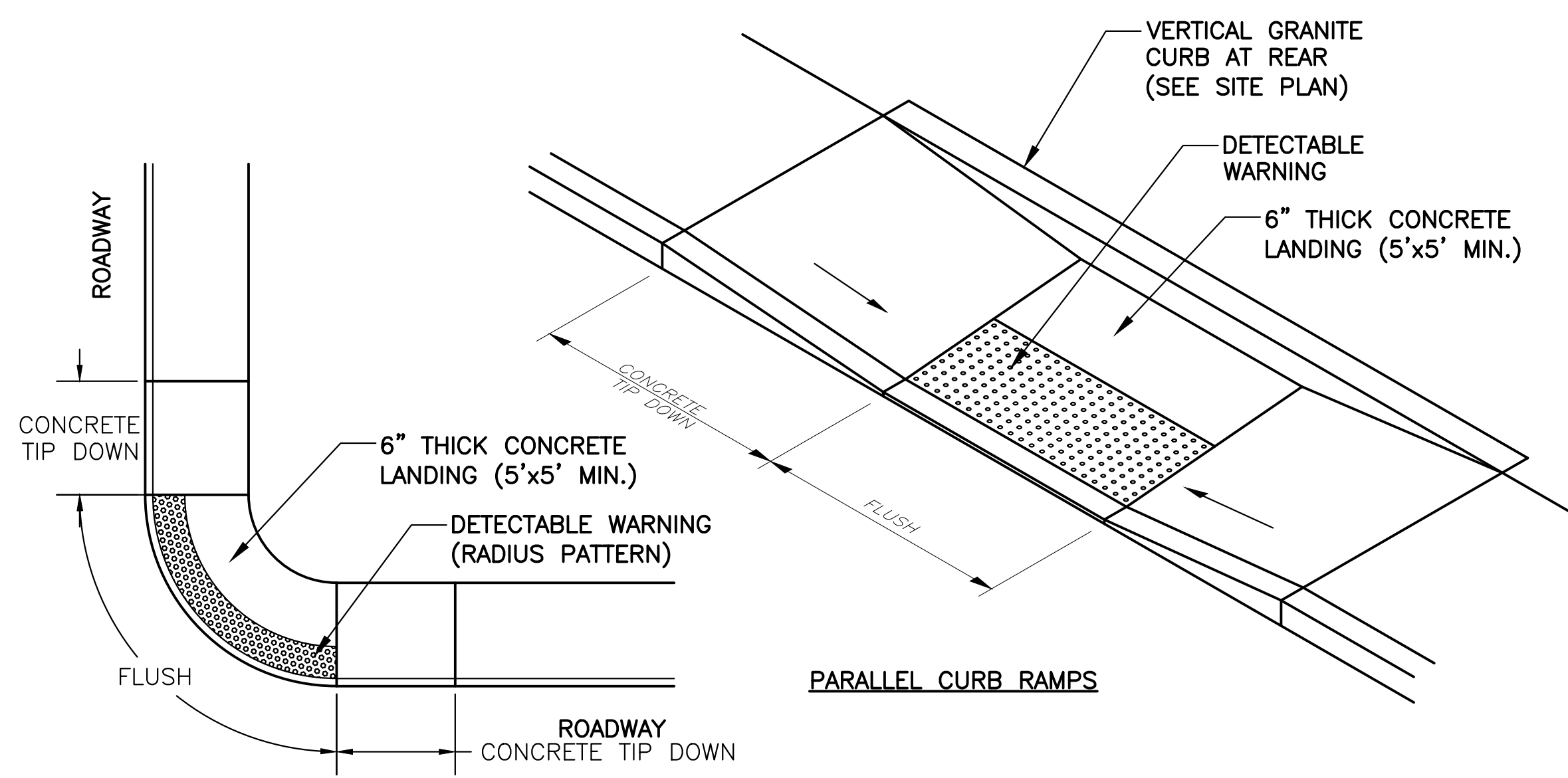

**RADI CURB RAMPS**

**PARALLEL CURB RAMPS**

**CURB RAMP DETAILS**  
SCALE: N.T.S.

- NOTES:**
- ALL CURB RAMPS AND SIDEWALKS SHALL COMPLY WITH ADA (AMERICANS WITH DISABILITIES ACT).
  - TIP DOWNS SHALL HAVE A RUNNING SLOPE OF 7.5% (8.0% MAX.) AND CROSS SLOPE OF 1.5% (1.0% MIN. & 1.8% MAX.).
  - THERE SHALL BE NO CHANGE IN ELEVATION (LIP) OR GAPS IN THE SIDEWALK RAMPS GREATER THAN 1/4".
  - LANDINGS AND AREAS OF CHANGE IN DIRECTION SHALL HAVE A SLOPE OF 1.5% (1.0% MIN. & 1.8% MAX.) IN ALL DIRECTIONS.
  - DETECTABLE WARNINGS SHALL BE INSTALLED SO THAT PATTERN IS IN LINE WITH DIRECTION OF TRAVEL TO THE EXTENT POSSIBLE.
  - DETECTABLE WARNING TILES SHALL BE PLACED SO THAT THE EDGE CLOSEST TO THE CURB IS BETWEEN 6"-8" FROM CURB LINE.
  - DETECTABLE WARNING TILE SHALL SPAN THE FULL WIDTH OF THE RAMP AND A MINIMUM OF 24" DEEP.
  - DETECTABLE WARNING TILE SHALL BE CAST IRON, NEENAH FOUNDRY OR APPROVED EQUAL. RADIUS ADA CURB RAMPS SHALL HAVE DETECTABLE WARNING TILES IN A RADIUS PATTERN USING TUFFILE OR APPROVED EQUAL.
  - CONCRETE AT DETECTABLE WARNING RAMPS SHALL BE FIBER REINFORCED WITH A MEDIUM BROOM FINISH.
  - BASE MATERIAL FOR CONCRETE SECTIONS SHALL BE EITHER 8" THK RECLAIM BASE (306.36), OR 8" THK CRUSHED GRAVEL BASE (NHDOT 304.3).

NO.	DESCRIPTION	MRB	DATE
0	ISSUED FOR CONSTRUCTION	MRB	05/06/21

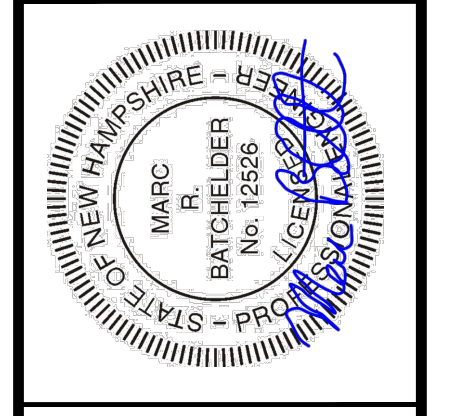

DATE: APRIL 2, 2020  
SCALE: AS SHOWN  
PROJECT NO.: COP-016  
MARC R. BATCHELDER, PE  
ENGINEER OF RECORD

FOR: City of Portsmouth  
Chevrolet Avenue  
Sidewalk

**Seaport Engineering, LLC**  
PORTSMOUTH, NH  
(603) 498-8449  
www.seaporteng.com

TITLE: CONSTRUCTION DETAILS

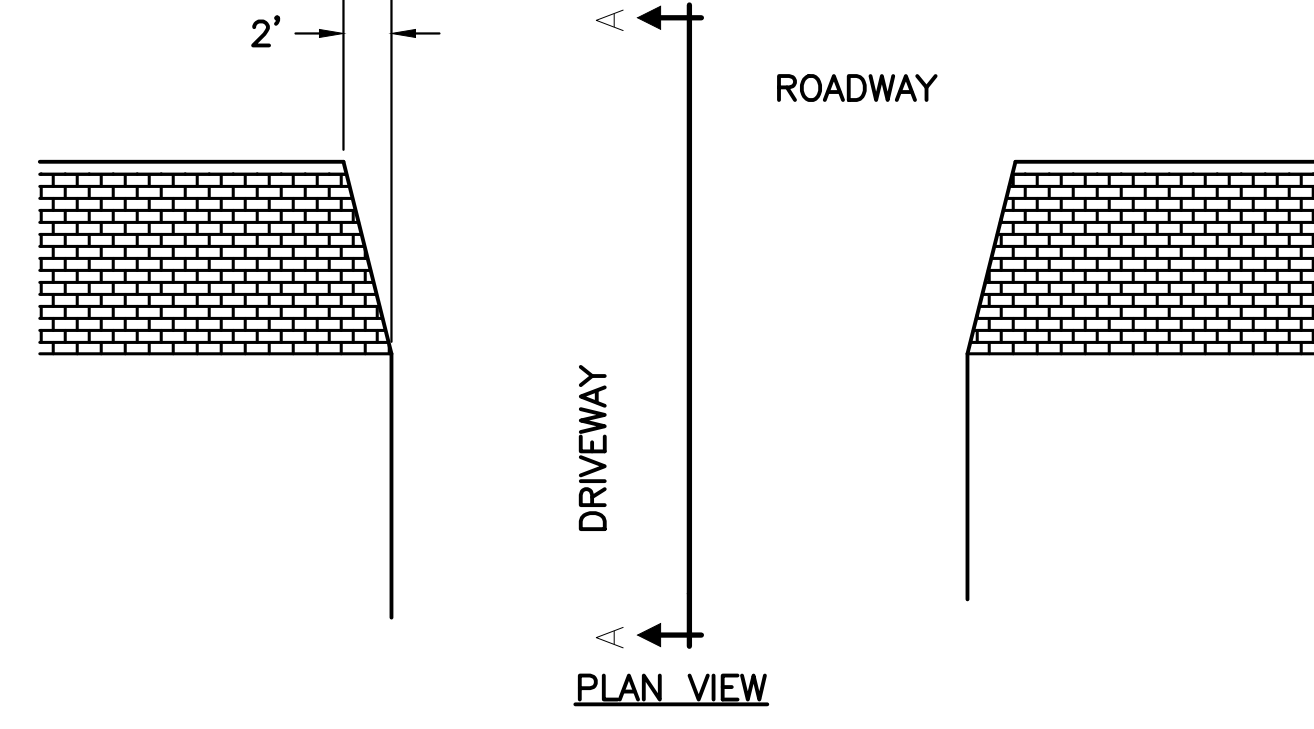

- NOTES:
1. DRIVEWAY PAVEMENT SHALL BE:  
1.5" WEARING (3/8" 50 GYRATION)  
1.5" BINDER (1/2" 50 GYRATION)
  2. ENGINEER TO DETERMINE IF EXISTING BASE MATERIALS ARE ACCEPTABLE.

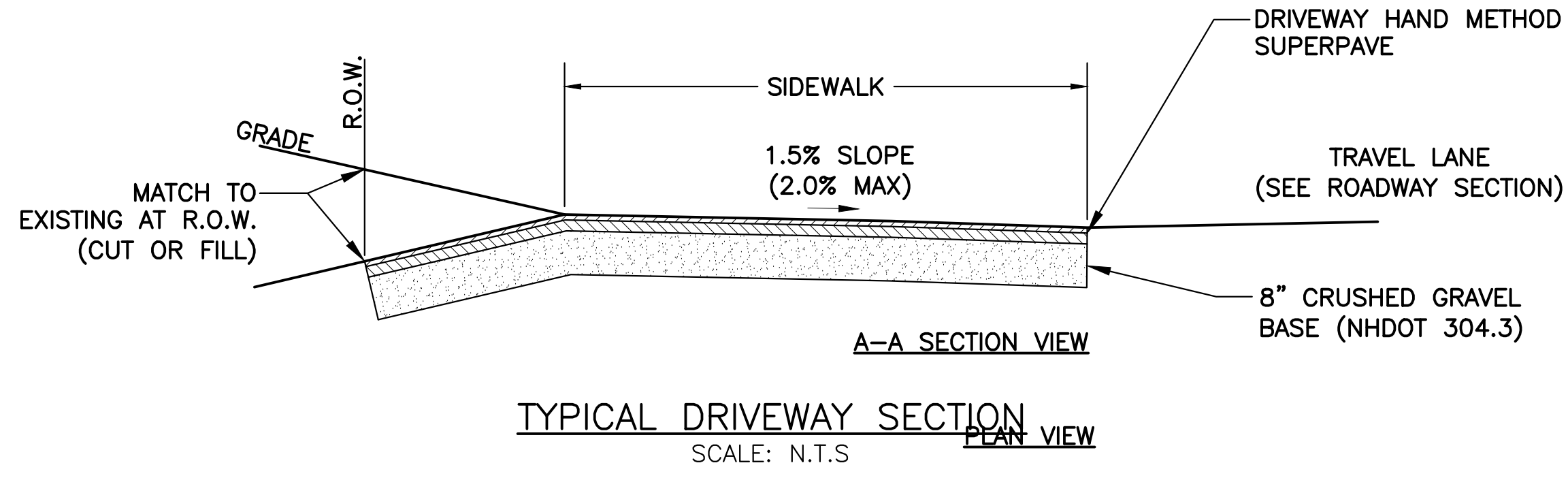

NO.	DESCRIPTION	APPD	DATE
0	ISSUED FOR CONSTRUCTION	MRB	05/06/21

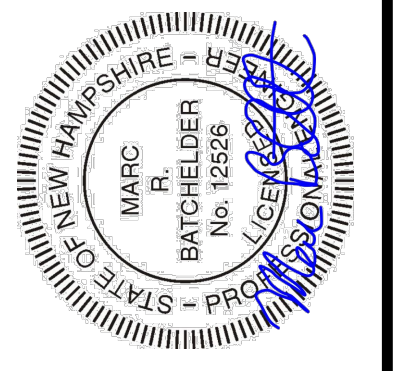

DATE: APRIL 2, 2020  
 SCALE: AS SHOWN  
 PROJECT NO.: COP-016  
 MARC R. BATCHELDER, PE  
 ENGINEER OF RECORD

FOR:  
 City of Portsmouth  
 Chevrolet Avenue  
 Sidewalk

**Seaport Engineering, LLC**  
 PORTSMOUTH, NH  
 (603) 498-8449  
 www.seaporteng.com

TITLE:  
 CONSTRUCTION DETAILS

C-203